

Drawings:

Volume 3 – RFP Drawings for construction part of the Work and RFP Drawings for design-build part of the Work

Delete the following drawings and in lieu thereof add the accompanying drawings:

<u>DELETE</u>	<u>ADD</u>	<u>DESCRIPTION</u>
S-100	S-100 AM3	Revised
S-101	S-101 AM3	Revised
S-102	S-102 AM3	Revised
S-103	S-103 AM3	Revised
S-104	S-104 AM3	Revised
S-105	S-105 AM3	Revised
S-106	S-106 AM3	Revised
S-107	S-107 AM3	Revised
S-108	S-108 AM3	Revised
S-109	S-109 AM3	Revised
S-110	S-110 AM3	Revised
A11-G-001	A11-G-001 AM3	Revised
A09-A-100	A09-A-100 AM3	Revised
A09-A-101	A09-A-101 AM3	Revised
A09-A-301	A09-A-301 AM3	Revised

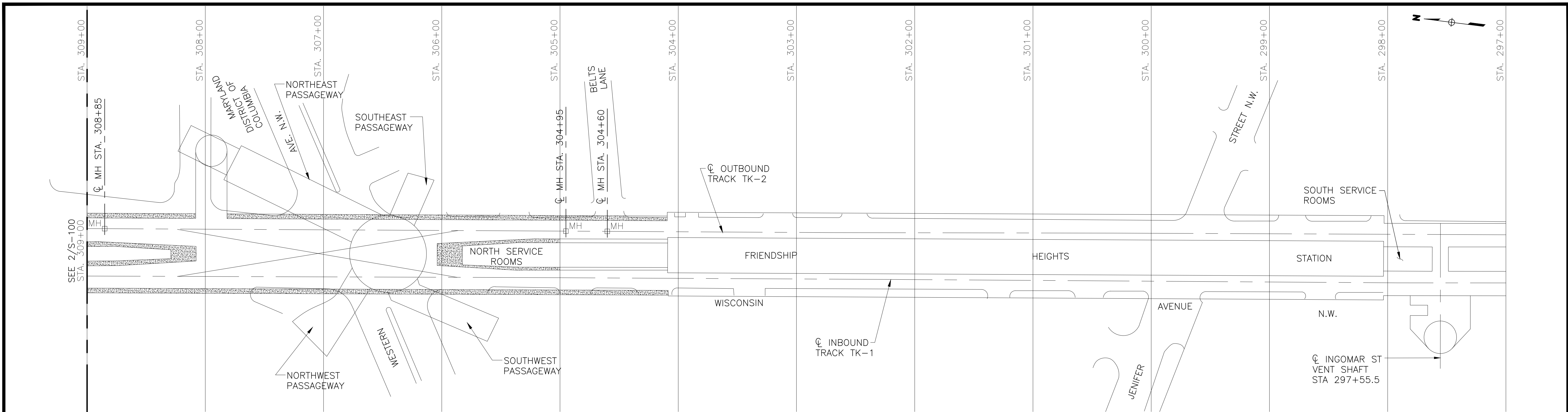

1  
S-100  
**STATIONING PLAN**  
SCALE: 1:500

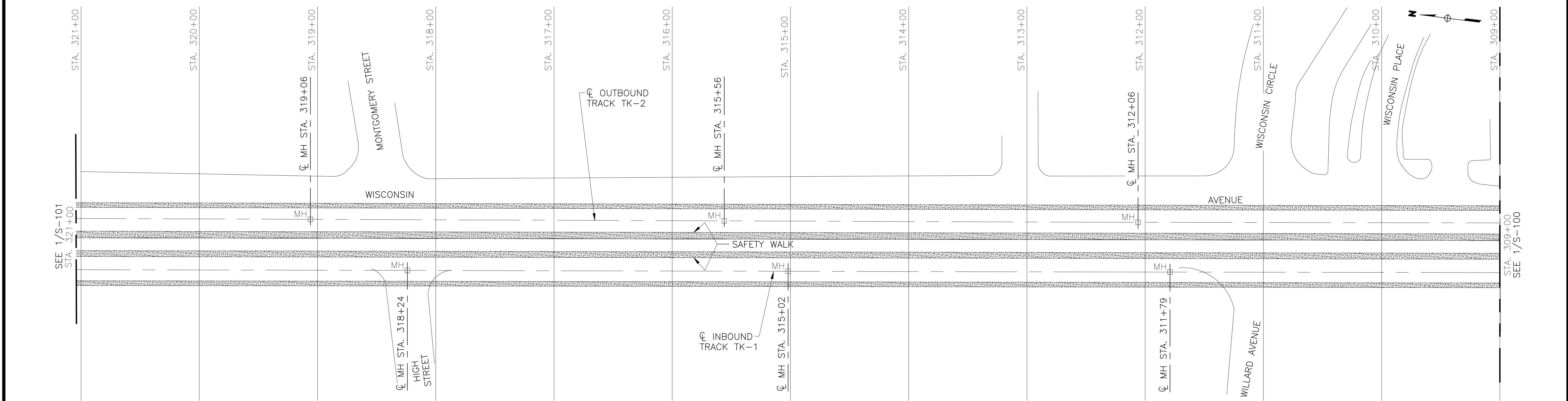

2  
S-100  
**STATIONING PLAN**  
SCALE: 1:500

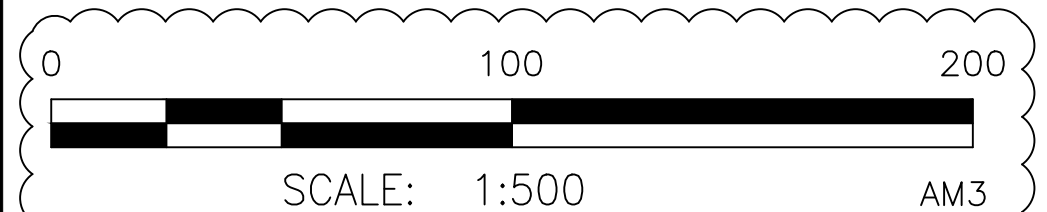

"PROFESSIONAL CERTIFICATION. I HEREBY CERTIFY THAT THESE DOCUMENTS WERE PREPARED OR APPROVED BY ME AND THAT I AM A DULY LICENSED PROFESSIONAL ENGINEER UNDER THE LAWS OF THE STATE OF MARYLAND, LICENSE NO. 22331, EXPIRATION DATE: 05-03-2015."

FINAL CONTRACT NO. FQ15093

DESIGNED	A. ZENDEK	01-15
		DATE
DRAWN	D. DILLON	01-15
		DATE
CHECKED	V. CECKA	01-15
		DATE
APPROVED	M. AVERSO	01-15
		DATE

REFERENCE DRAWINGS	
NUMBER	DESCRIPTION

REVISIONS		
NUMBER	DATE	DESCRIPTION



**WASHINGTON METROPOLITAN AREA TRANSIT AUTHORITY**

DEPARTMENT OF TRANSIT INFRASTRUCTURE AND ENGINEERING SERVICES  
OFFICE OF INFRASTRUCTURE RENEWAL PROGRAM

**GFP** A Gannett Fleming/Parsons JOINT VENTURE

APPROVED \_\_\_\_\_ SUBMITTED \_\_\_\_\_ PROJECT MANAGER

**RED LINE REHAB.-FRIENDSHIP HEIGHTS TO GROSVENOR - PART 1**

STATIONING PLANS

SCALE AS NOTED DRAWING NO. S-100 SHEET NO. M1272-012

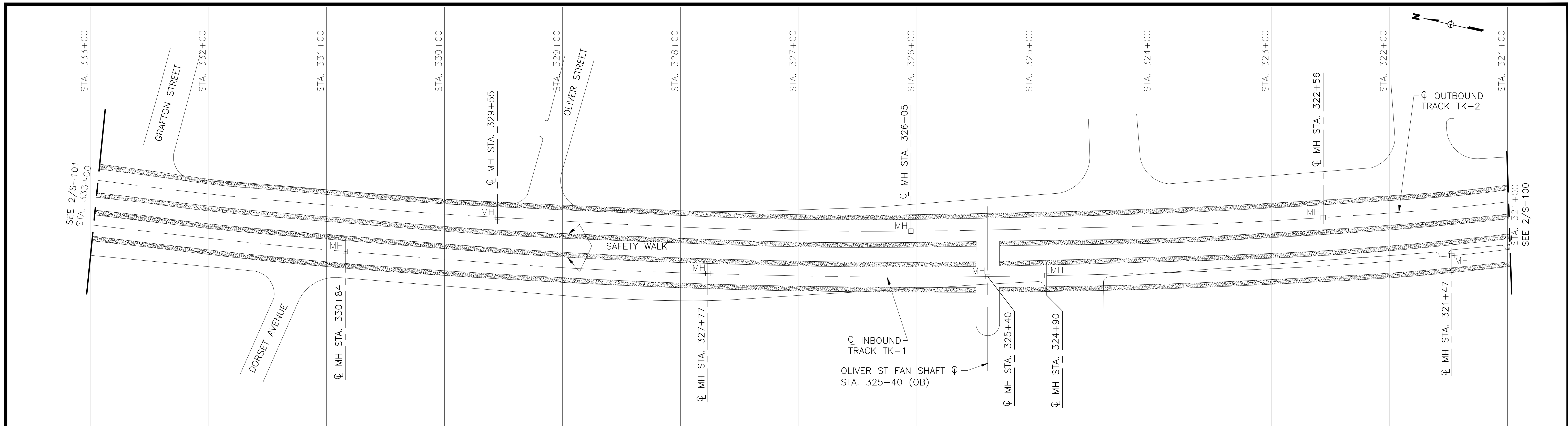

**1**  
S-101  
**STATIONING PLAN**  
SCALE: 1:500

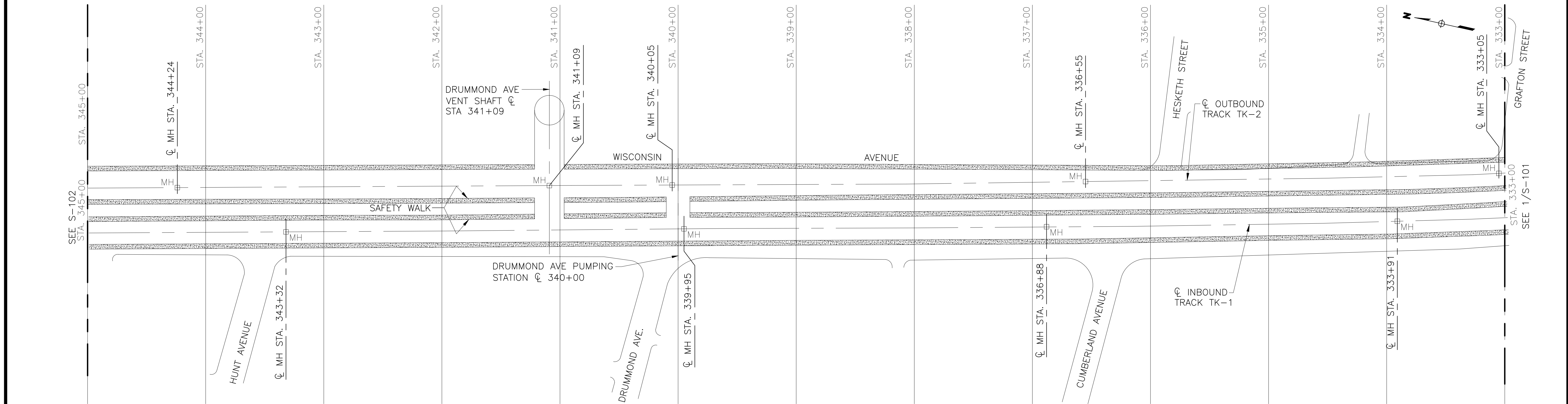

**2**  
S-101  
**STATIONING PLAN**  
SCALE: 1:500

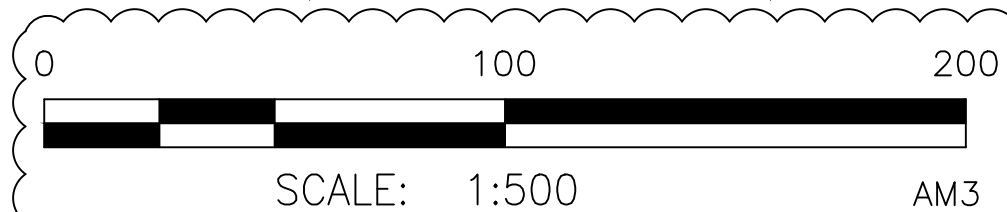

"PROFESSIONAL CERTIFICATION. I HEREBY CERTIFY THAT THESE DOCUMENTS WERE PREPARED OR APPROVED BY ME AND THAT I AM A DULY LICENSED PROFESSIONAL ENGINEER UNDER THE LAWS OF THE STATE OF MARYLAND, LICENSE NO. 22331, EXPIRATION DATE: 05-03-2015."

FINAL CONTRACT NO. **FQ15093**

DESIGNED			REFERENCE DRAWINGS			REVISIONS		
NUMBER	DESCRIPTION	DATE	BY	DESCRIPTION	DATE	BY	DESCRIPTION	DATE
01-15	A. ZENDEK	01-15	07-15	VC	CHANGED BAR SCALE			AM 3'
01-15	D. DILLON	01-15						
01-15	V. CECKA	01-15						
01-15	M. AVERSO	01-15						



**WASHINGTON METROPOLITAN AREA TRANSIT AUTHORITY**  
 DEPARTMENT OF TRANSIT INFRASTRUCTURE AND ENGINEERING SERVICES  
 OFFICE OF INFRASTRUCTURE RENEWAL PROGRAM  
 APPROVED \_\_\_\_\_

**GFP** A Gannett Fleming/Parsons JOINT VENTURE  
 SUBMITTED \_\_\_\_\_  
 PROJECT MANAGER

**RED LINE REHAB.-FRIENDSHIP HEIGHTS TO GROSVENOR - PART 1**  
 STATIONING PLANS  
 SCALE AS NOTED DRAWING NO. **S-101** SHEET NO. **M1272-013**

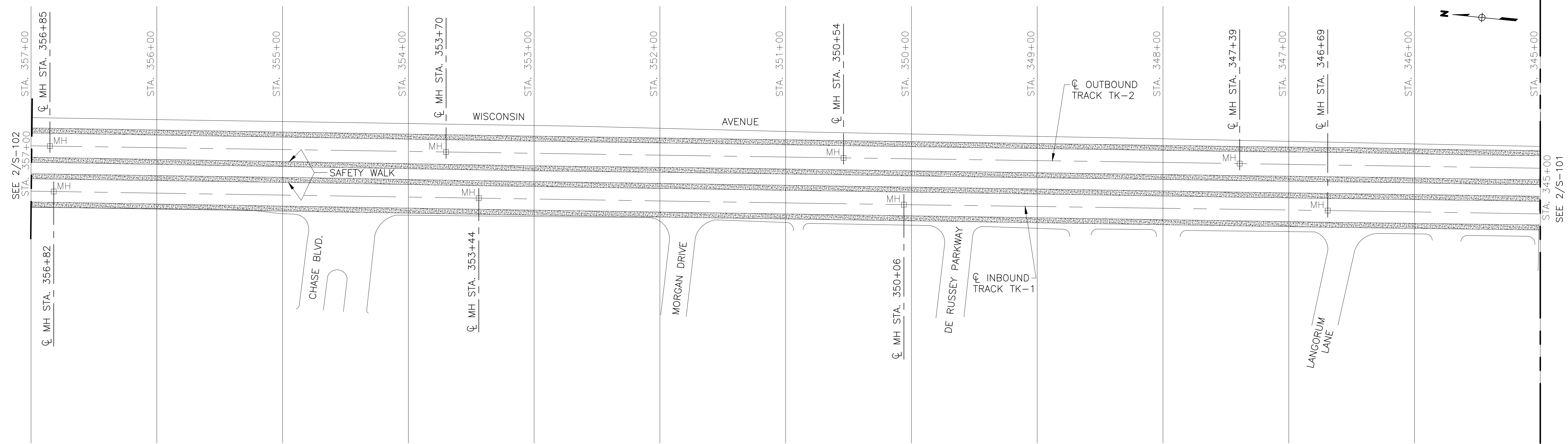

1  
S-102  
**STATIONING PLAN**  
SCALE: 1:500

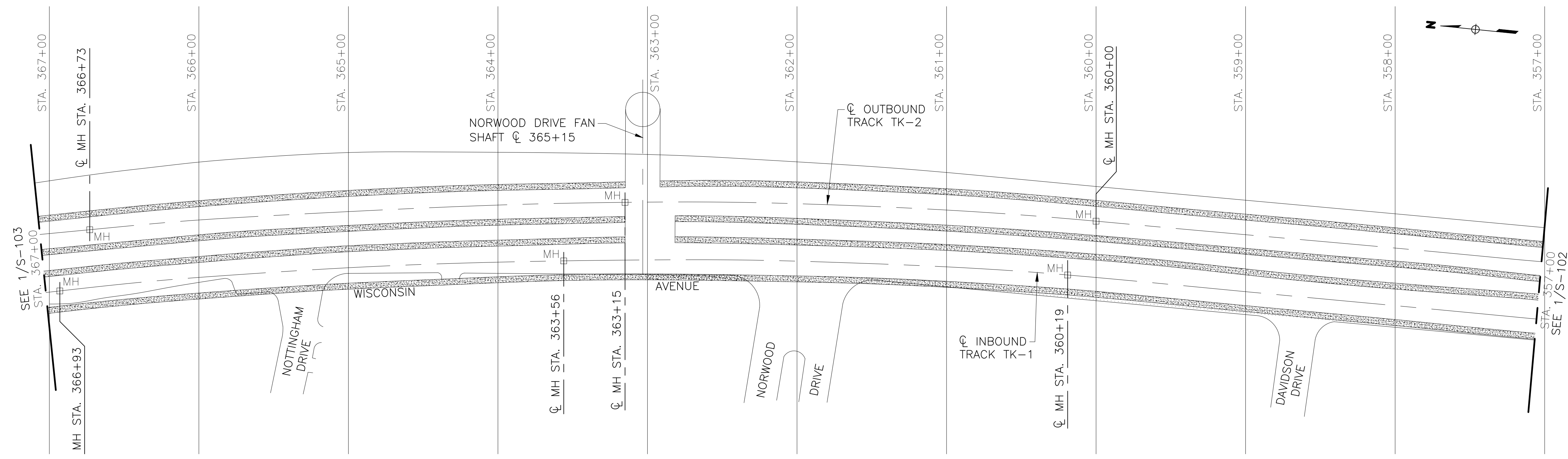

2  
S-102  
**STATIONING PLAN**  
SCALE: 1:500

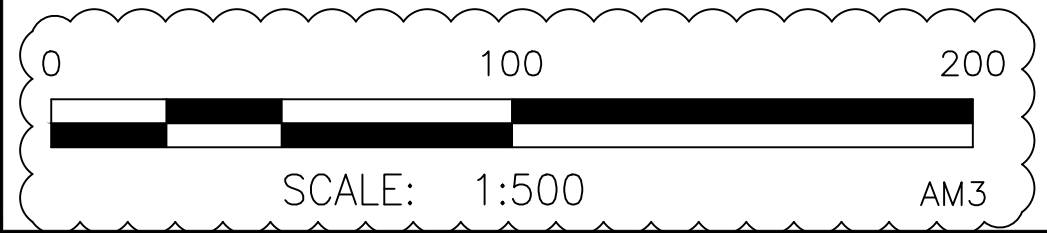

"PROFESSIONAL CERTIFICATION. I HEREBY CERTIFY THAT THESE DOCUMENTS WERE PREPARED OR APPROVED BY ME AND THAT I AM A DULY LICENSED PROFESSIONAL ENGINEER UNDER THE LAWS OF THE STATE OF MARYLAND, LICENSE NO. 22331, EXPIRATION DATE: 05-03-2015."

FINAL CONTRACT NO. FQ15093

DESIGNED			REFERENCE DRAWINGS			REVISIONS		
DATE	BY	DESCRIPTION	NUMBER	DESCRIPTION	DATE	BY	DESCRIPTION	DATE
01-15	A. ZENDEK				07-15	VC	CHANGED BAR SCALE	AM 3
01-15	D. DILLON							
01-15	V. CECKA							
01-15	M. AVERSO							



**WASHINGTON METROPOLITAN AREA TRANSIT AUTHORITY**

DEPARTMENT OF TRANSIT INFRASTRUCTURE AND ENGINEERING SERVICES  
OFFICE OF INFRASTRUCTURE RENEWAL PROGRAM

APPROVED \_\_\_\_\_

**GFP** A Gannett Fleming/Parsons JOINT VENTURE

SUBMITTED \_\_\_\_\_  
PROJECT MANAGER

**RED LINE REHAB.-FRIENDSHIP HEIGHTS TO GROSVENOR - PART 1**

STATIONING PLANS

SCALE: AS NOTED  
DRAWING NO.: S-102  
SHEET NO.: M1272-014

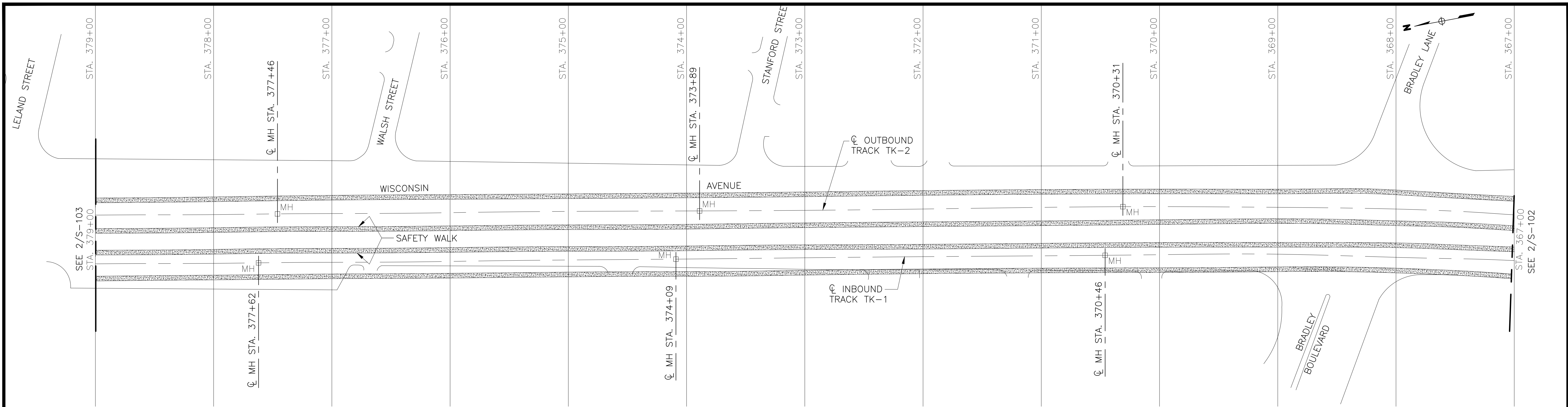

1  
S-103  
**STATIONING PLAN**  
SCALE: 1:500

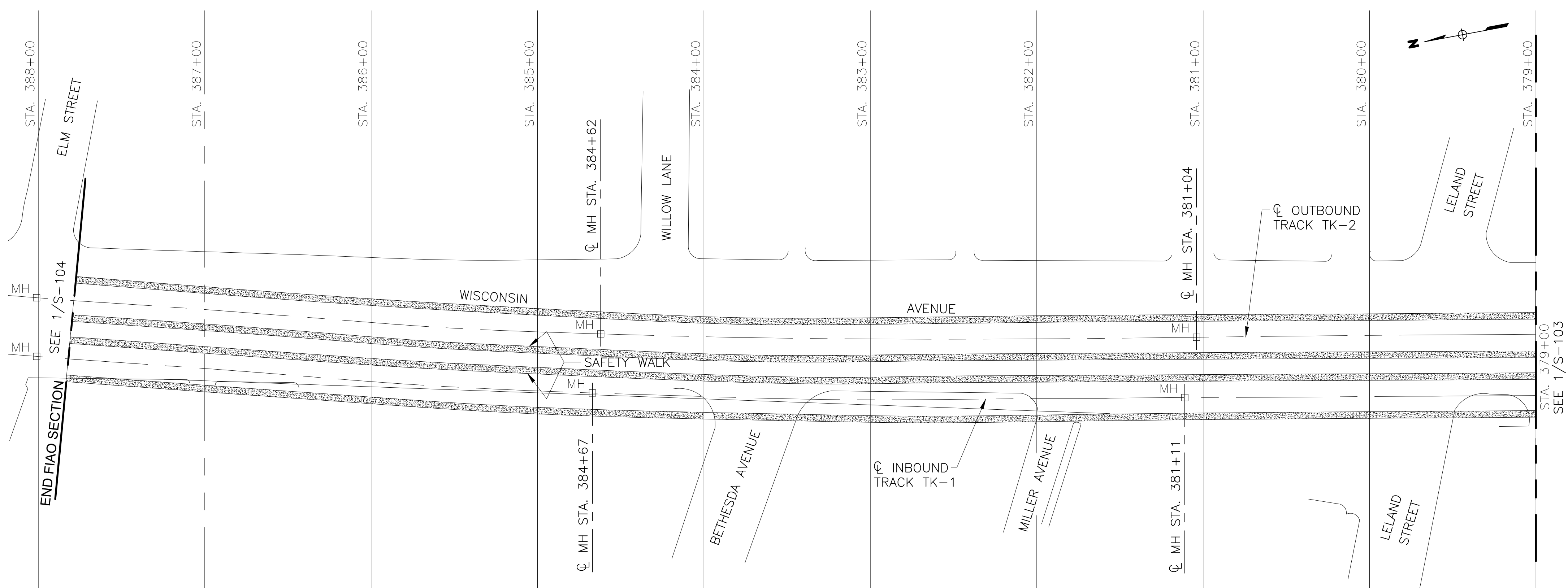

2  
S-103  
**STATIONING PLAN**  
SCALE: 1:500

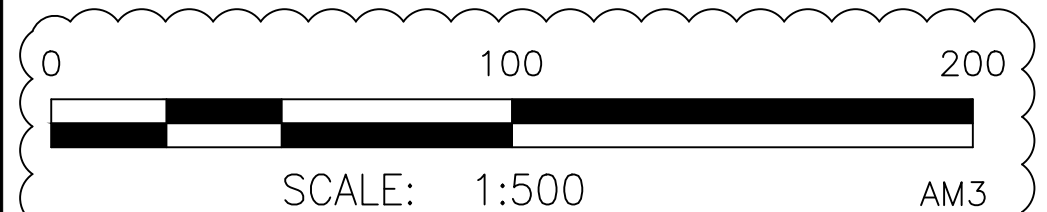

"PROFESSIONAL CERTIFICATION. I HEREBY CERTIFY THAT THESE DOCUMENTS WERE PREPARED OR APPROVED BY ME AND THAT I AM A DULY LICENSED PROFESSIONAL ENGINEER UNDER THE LAWS OF THE STATE OF MARYLAND, LICENSE NO. 22331, EXPIRATION DATE: 05-03-2015."

FINAL CONTRACT NO. FQ15093

DESIGNED			REFERENCE DRAWINGS			REVISIONS		
NUMBER	DESCRIPTION	DATE	BY	DESCRIPTION	DATE	BY	DESCRIPTION	DATE
01-15	A. ZENDEK	01-15	07-15	VC	CHANGED BAR SCALE			AM 3'
01-15	D. DILLON	01-15						
01-15	V. CECKA	01-15						
01-15	M. AVERSO	01-15						



**WASHINGTON METROPOLITAN AREA TRANSIT AUTHORITY**

DEPARTMENT OF TRANSIT INFRASTRUCTURE AND ENGINEERING SERVICES  
OFFICE OF INFRASTRUCTURE RENEWAL PROGRAM

APPROVED \_\_\_\_\_

**GFP** A Gannett Fleming/Parsons JOINT VENTURE

SUBMITTED \_\_\_\_\_  
PROJECT MANAGER

**RED LINE REHAB.-FRIENDSHIP HEIGHTS TO GROSVENOR - PART 1**

STATIONING PLANS

SCALE AS NOTED DRAWING NO. S-103 SHEET NO. M1272-015

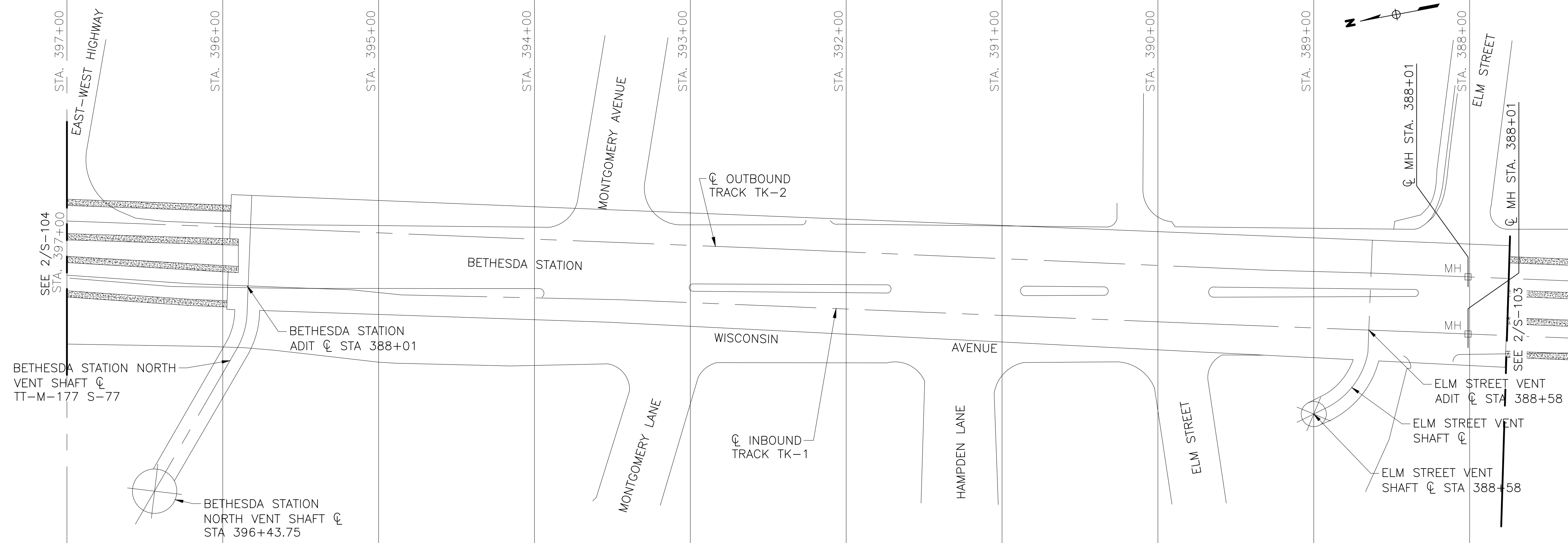

1  
S-104  
**STATIONING PLAN**  
SCALE: 1:500

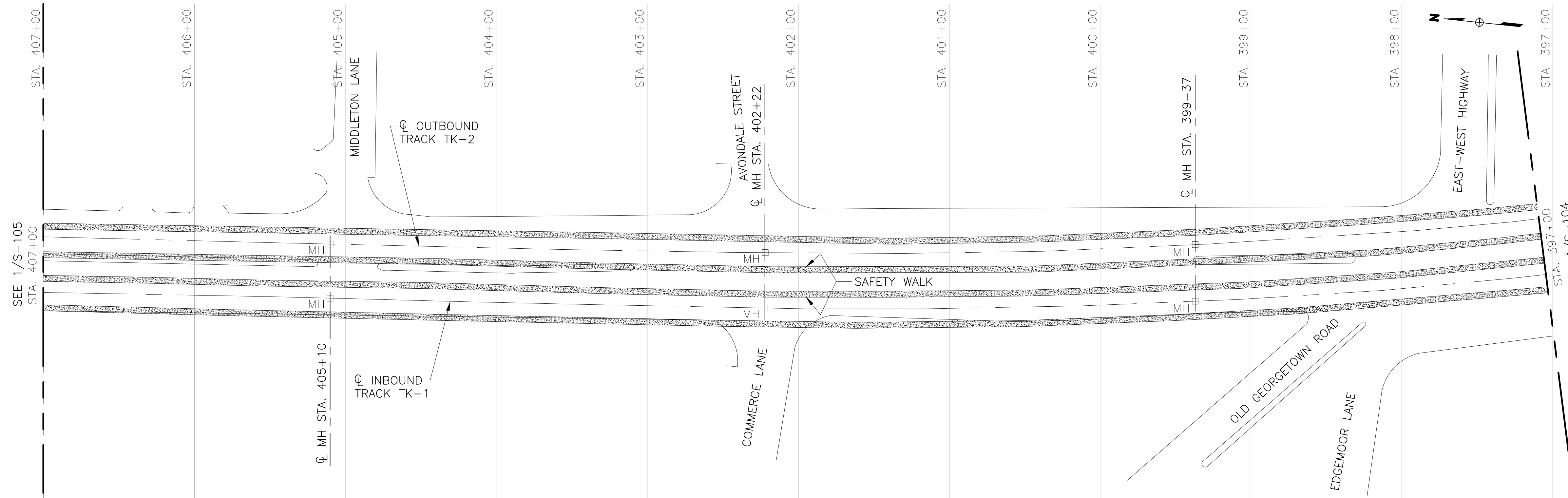

2  
S-104  
**STATIONING PLAN**  
SCALE: 1:500

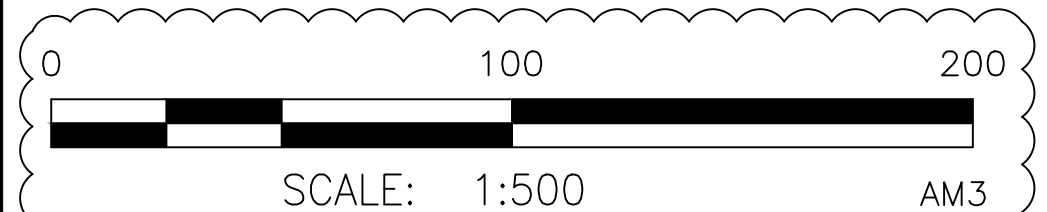

"PROFESSIONAL CERTIFICATION. I HEREBY CERTIFY THAT THESE DOCUMENTS WERE PREPARED OR APPROVED BY ME AND THAT I AM A DULY LICENSED PROFESSIONAL ENGINEER UNDER THE LAWS OF THE STATE OF MARYLAND, LICENSE NO. 22331, EXPIRATION DATE: 05-03-2015."

FINAL CONTRACT NO. FQ15093

DESIGNED			REFERENCE DRAWINGS			REVISIONS		
DATE	BY	DESCRIPTION	NUMBER	DESCRIPTION	DATE	BY	DESCRIPTION	AM
01-15	A. ZENDEK				07-15	VC	CHANGED BAR SCALE	AM 3'
01-15	D. DILLON							
01-15	V. CECKA							
01-15	M. AVERSO							



**WASHINGTON METROPOLITAN AREA TRANSIT AUTHORITY**

DEPARTMENT OF TRANSIT INFRASTRUCTURE AND ENGINEERING SERVICES  
OFFICE OF INFRASTRUCTURE RENEWAL PROGRAM

APPROVED \_\_\_\_\_

**GFP** A Gannett Fleming/Parsons JOINT VENTURE

SUBMITTED \_\_\_\_\_  
PROJECT MANAGER

**RED LINE REHAB.-FRIENDSHIP HEIGHTS TO GROSVENOR - PART 1**

STATIONING PLANS

SCALE AS NOTED DRAWING NO. S-104 SHEET NO. M1272-016

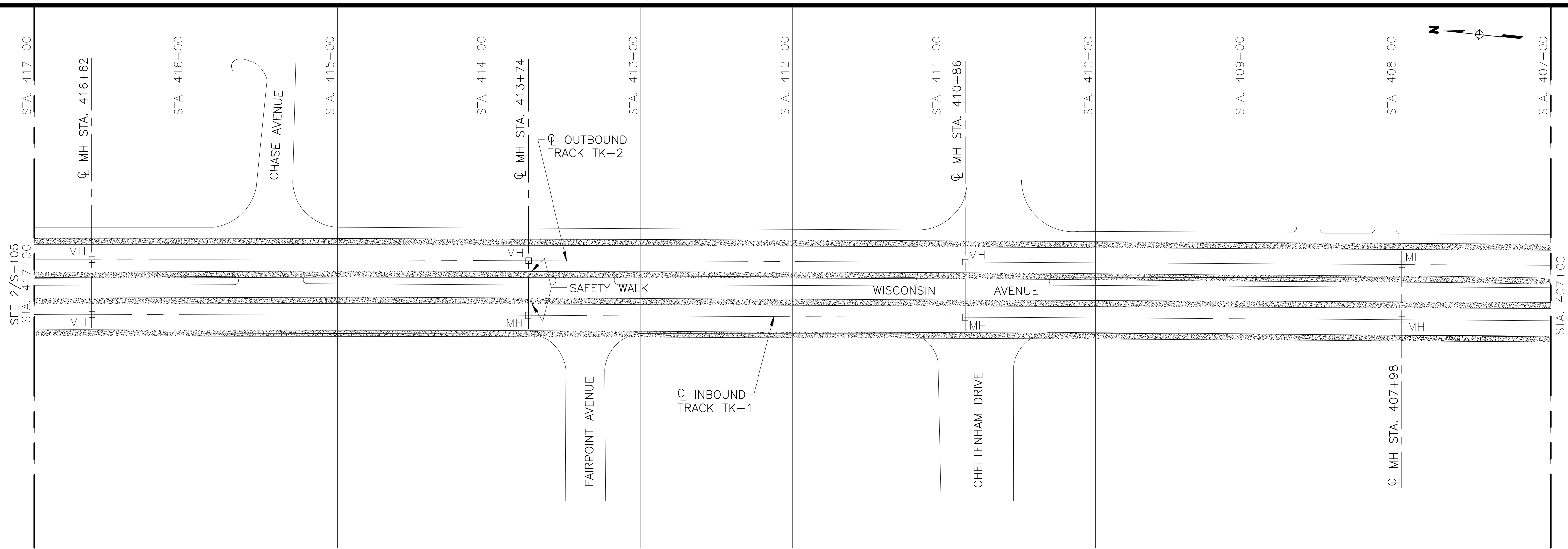

**1 STATIONING PLAN**  
SCALE: 1:500

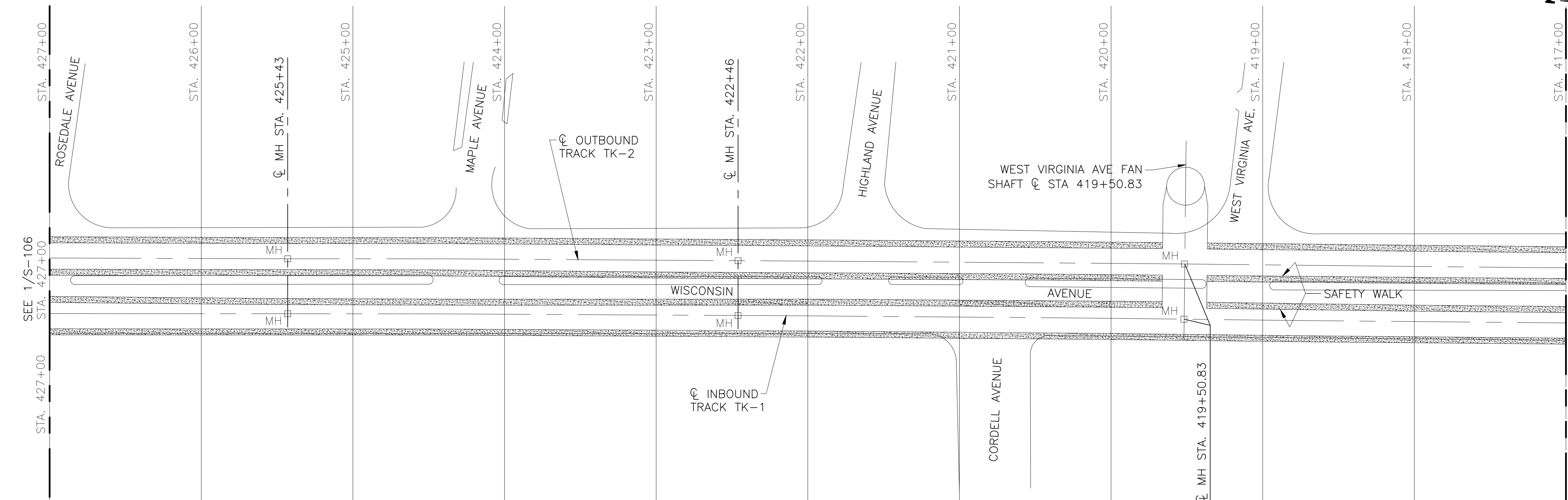

**2 STATIONING PLAN**  
SCALE: 1:500

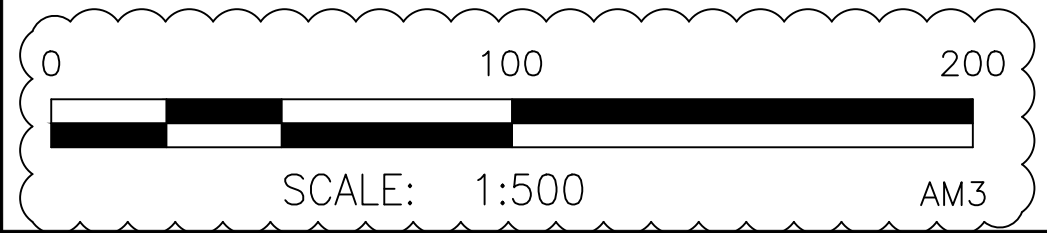

"PROFESSIONAL CERTIFICATION. I HEREBY CERTIFY THAT THESE DOCUMENTS WERE PREPARED OR APPROVED BY ME AND THAT I AM A DULY LICENSED PROFESSIONAL ENGINEER UNDER THE LAWS OF THE STATE OF MARYLAND, LICENSE NO. 22331, EXPIRATION DATE: 05-03-2015."

FINAL CONTRACT NO. FQ15093

DESIGNED			REFERENCE DRAWINGS			REVISIONS		
DATE	DESCRIPTION	NUMBER	DATE	BY	DESCRIPTION	DATE	BY	DESCRIPTION
01-15	A. ZENDEK		07-15	VC	CHANGED BAR SCALE			
01-15	D. DILLON							
01-15	V. CECKA							
01-15	M. AVERSO							



**WASHINGTON METROPOLITAN AREA TRANSIT AUTHORITY**

DEPARTMENT OF TRANSIT INFRASTRUCTURE AND ENGINEERING SERVICES  
OFFICE OF INFRASTRUCTURE RENEWAL PROGRAM

**GFP** A Gannett Fleming/Parsons JOINT VENTURE

APPROVED \_\_\_\_\_ SUBMITTED \_\_\_\_\_ PROJECT MANAGER

**RED LINE REHAB.-FRIENDSHIP HEIGHTS TO GROSVENOR - PART 1**

STATIONING PLANS

SCALE AS NOTED DRAWING NO. S-105 SHEET NO. M1272-017

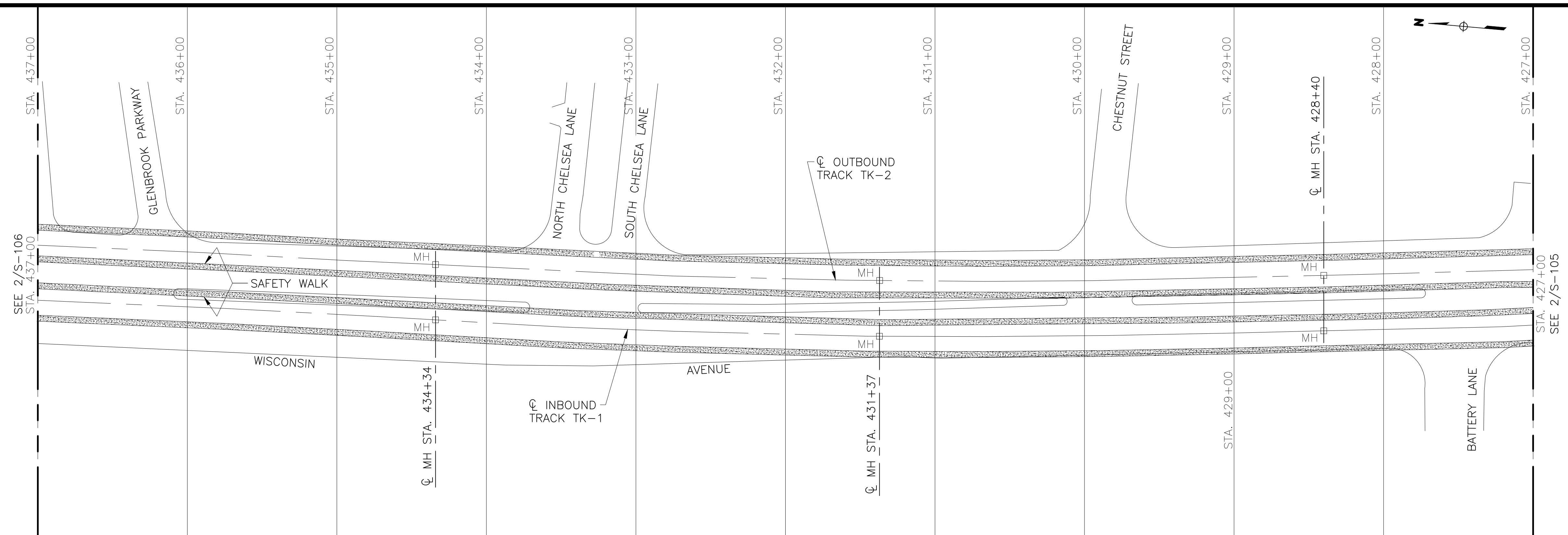

1  
S-106  
**STATIONING PLAN**  
SCALE: 1:500

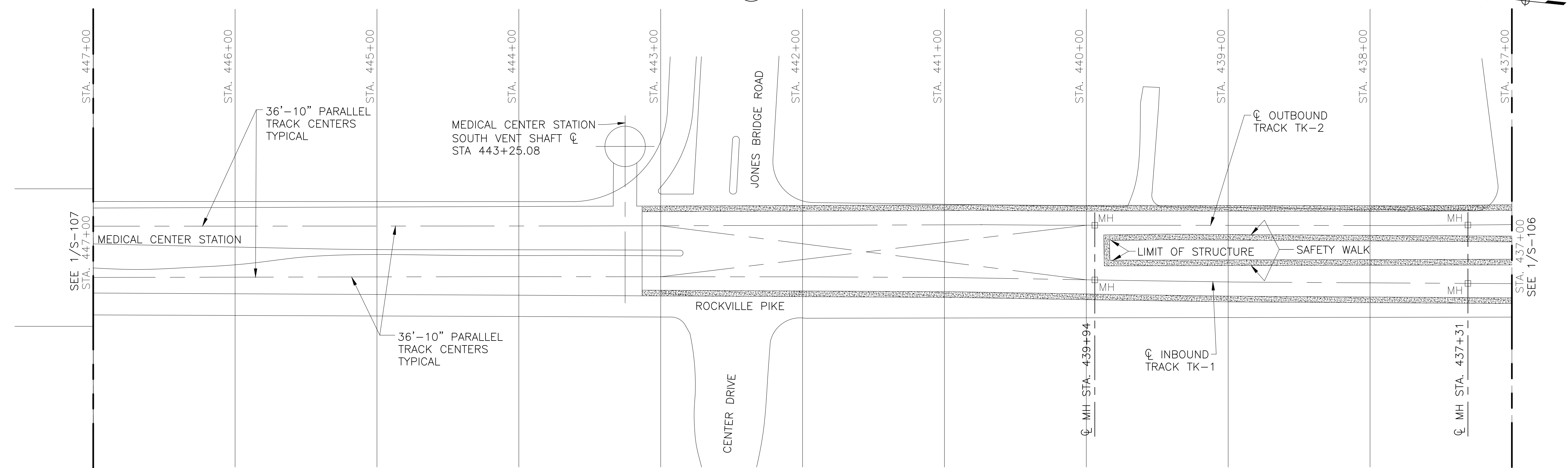

2  
S-106  
**STATIONING PLAN**  
SCALE: 1:500

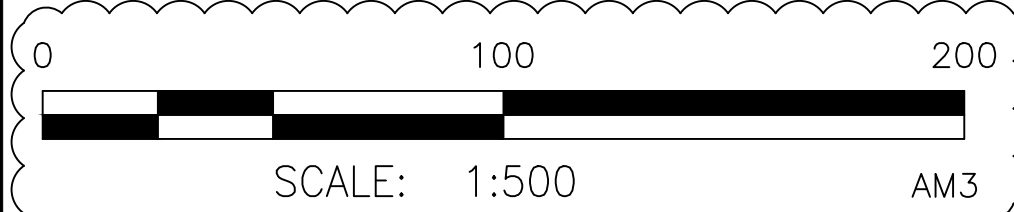

"PROFESSIONAL CERTIFICATION. I HEREBY CERTIFY THAT THESE DOCUMENTS WERE PREPARED OR APPROVED BY ME AND THAT I AM A DULY LICENSED PROFESSIONAL ENGINEER UNDER THE LAWS OF THE STATE OF MARYLAND, LICENSE NO. 22331, EXPIRATION DATE: 05-03-2015."

FINAL CONTRACT NO. FQ15093

DESIGNED	A. ZENDEK	01-15
		DATE
DRAWN	D. DILLON	01-15
		DATE
CHECKED	V. CECKA	01-15
		DATE
APPROVED	M. AVERSO	01-15
		DATE

REFERENCE DRAWINGS	
NUMBER	DESCRIPTION

REVISIONS		
NUMBER	DATE	DESCRIPTION



**WASHINGTON METROPOLITAN AREA TRANSIT AUTHORITY**

DEPARTMENT OF TRANSIT INFRASTRUCTURE AND ENGINEERING SERVICES  
OFFICE OF INFRASTRUCTURE RENEWAL PROGRAM

**GFP** A Gannett Fleming/Parsons JOINT VENTURE

APPROVED \_\_\_\_\_ SUBMITTED \_\_\_\_\_ PROJECT MANAGER

**RED LINE REHAB.-FRIENDSHIP HEIGHTS TO GROSVENOR - PART 1**

STATIONING PLANS

SCALE AS NOTED DRAWING NO. S-106 SHEET NO. M1272-018



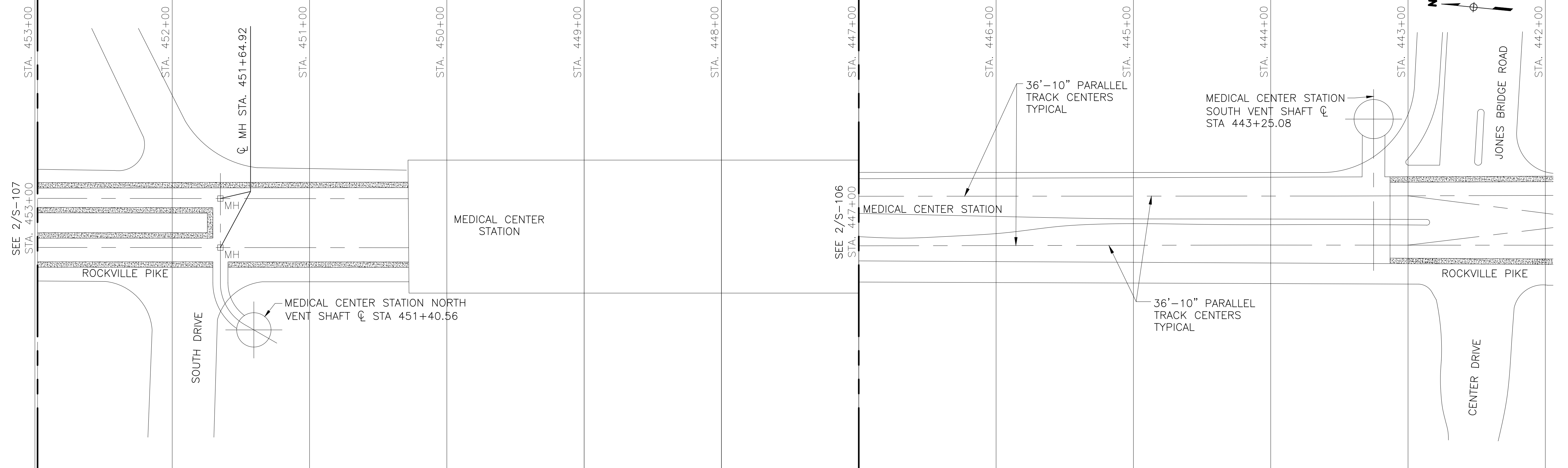

**1**  
S-107  
**STATIONING PLAN**  
SCALE: 1:500

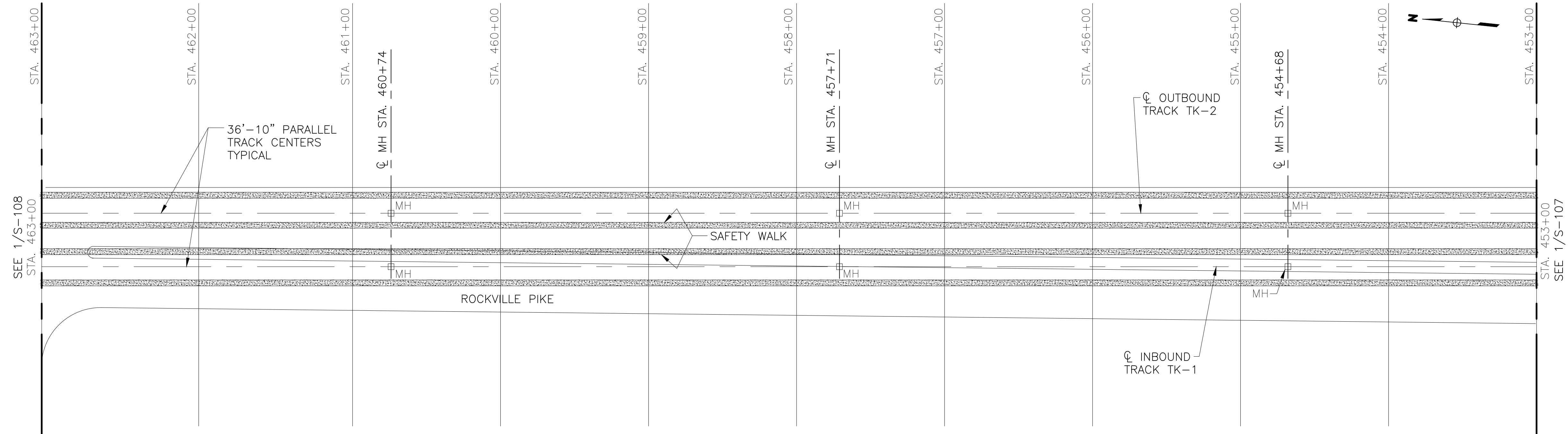

**2**  
S-107  
**STATIONING PLAN**  
SCALE: 1:500

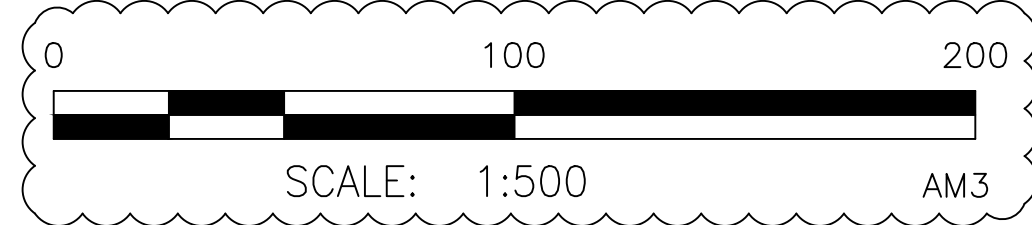

"PROFESSIONAL CERTIFICATION. I HEREBY CERTIFY THAT THESE DOCUMENTS WERE PREPARED OR APPROVED BY ME AND THAT I AM A DULY LICENSED PROFESSIONAL ENGINEER UNDER THE LAWS OF THE STATE OF MARYLAND, LICENSE NO. 22331, EXPIRATION DATE: 05-03-2015."

FINAL CONTRACT NO. FQ15093

DESIGNED			REFERENCE DRAWINGS			REVISIONS		
DATE	DESCRIPTION	NUMBER	DATE	BY	DESCRIPTION	DATE	BY	DESCRIPTION
01-15	A. ZENDEK					07-15	VC	CHANGED BAR SCALE AM 3'
01-15	D. DILLON							
01-15	V. CECKA							
01-15	M. AVERSO							



**WASHINGTON METROPOLITAN AREA TRANSIT AUTHORITY**

DEPARTMENT OF TRANSIT INFRASTRUCTURE AND ENGINEERING SERVICES  
OFFICE OF INFRASTRUCTURE RENEWAL PROGRAM

APPROVED \_\_\_\_\_

**GFP** A Gannett Fleming/Parsons JOINT VENTURE

SUBMITTED \_\_\_\_\_  
PROJECT MANAGER

**RED LINE REHAB.-FRIENDSHIP HEIGHTS TO GROSVENOR - PART 1**

STATIONING PLANS

SCALE AS NOTED DRAWING NO. S-107 SHEET NO. M1272-019

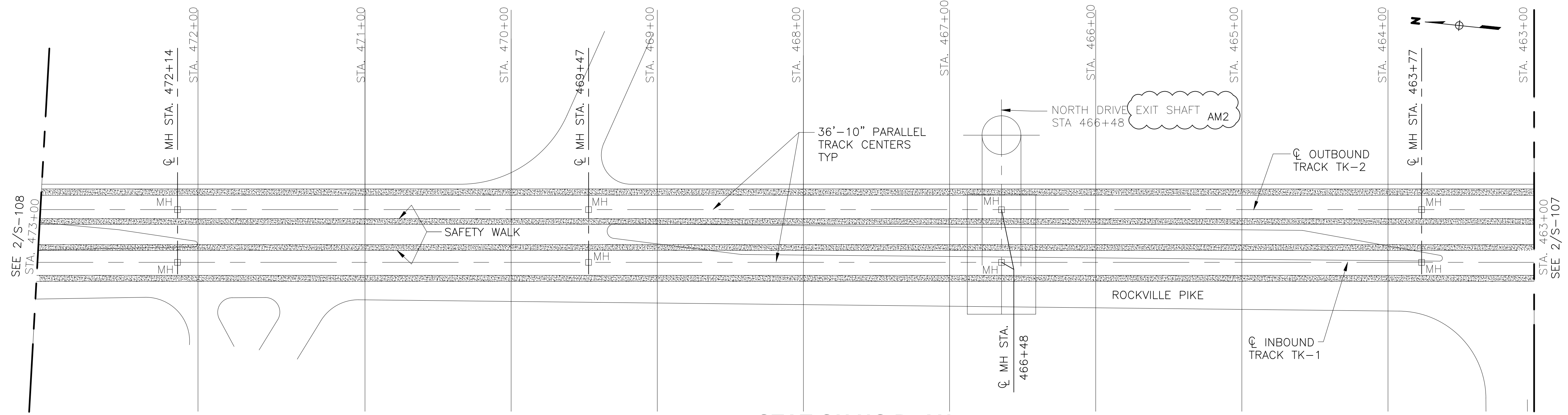

1  
S-108 STATIONING PLAN  
SCALE: 1:500

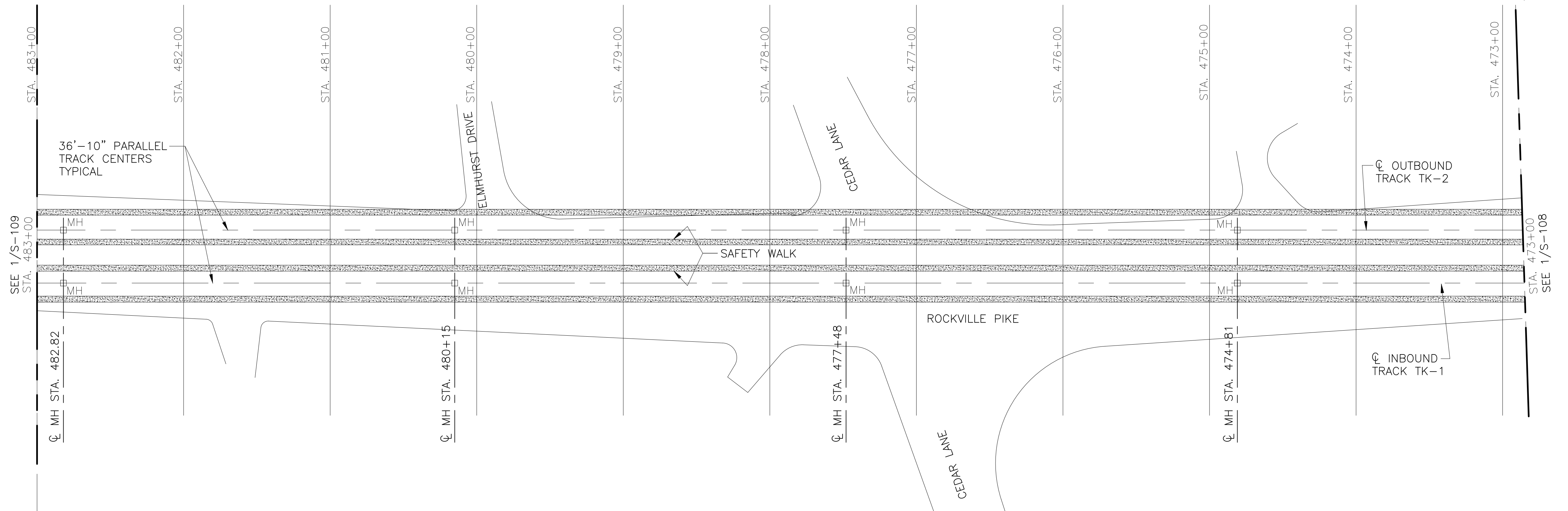

2  
S-108 STATIONING PLAN  
SCALE: 1:500

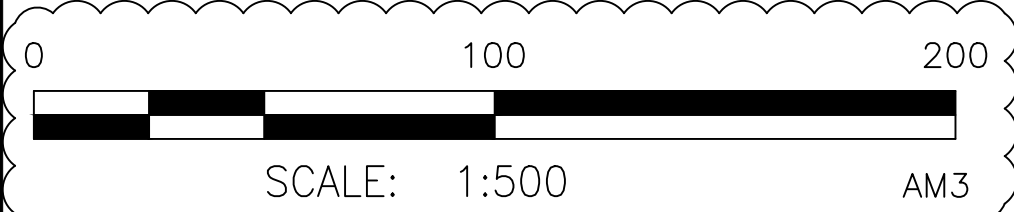

"PROFESSIONAL CERTIFICATION. I HEREBY CERTIFY THAT THESE DOCUMENTS WERE PREPARED OR APPROVED BY ME AND THAT I AM A DULY LICENSED PROFESSIONAL ENGINEER UNDER THE LAWS OF THE STATE OF MARYLAND, LICENSE NO. 22331, EXPIRATION DATE: 05-03-2015."

FINAL CONTRACT NO. FQ15093

DESIGNED	A. ZENDEK	01-15
		DATE
DRAWN	D. DILLON	01-15
		DATE
CHECKED	V. CECKA	01-15
		DATE
APPROVED	M. AVERSO	01-15
		DATE

REFERENCE DRAWINGS	
NUMBER	DESCRIPTION

REVISIONS			
NUMBER	DATE	BY	DESCRIPTION



**WASHINGTON METROPOLITAN AREA TRANSIT AUTHORITY**

DEPARTMENT OF TRANSIT INFRASTRUCTURE AND ENGINEERING SERVICES  
OFFICE OF INFRASTRUCTURE RENEWAL PROGRAM

APPROVED \_\_\_\_\_

**GFP** A Gannett Fleming/Parsons JOINT VENTURE

SUBMITTED \_\_\_\_\_  
PROJECT MANAGER

**RED LINE REHAB.-FRIENDSHIP HEIGHTS TO GROSVENOR - PART 1**

STATIONING PLANS

SCALE AS NOTED	DRAWING NO. S-108	SHEET NO. M1272-020
-------------------	----------------------	------------------------

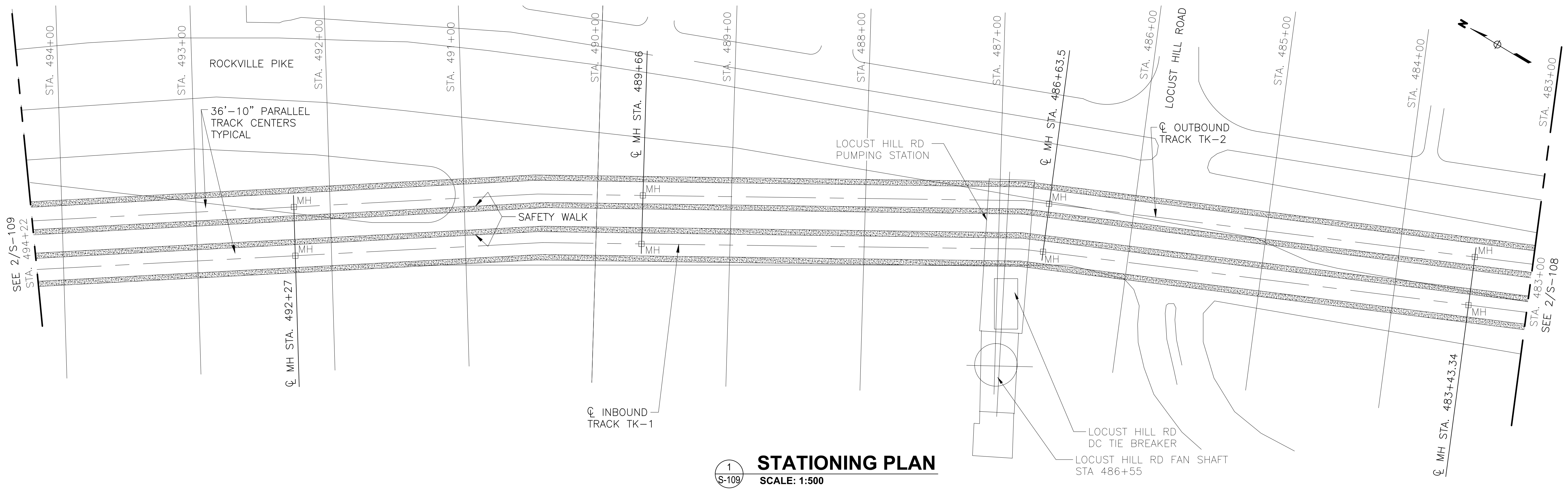

1  
S-109  
**STATIONING PLAN**  
SCALE: 1:500

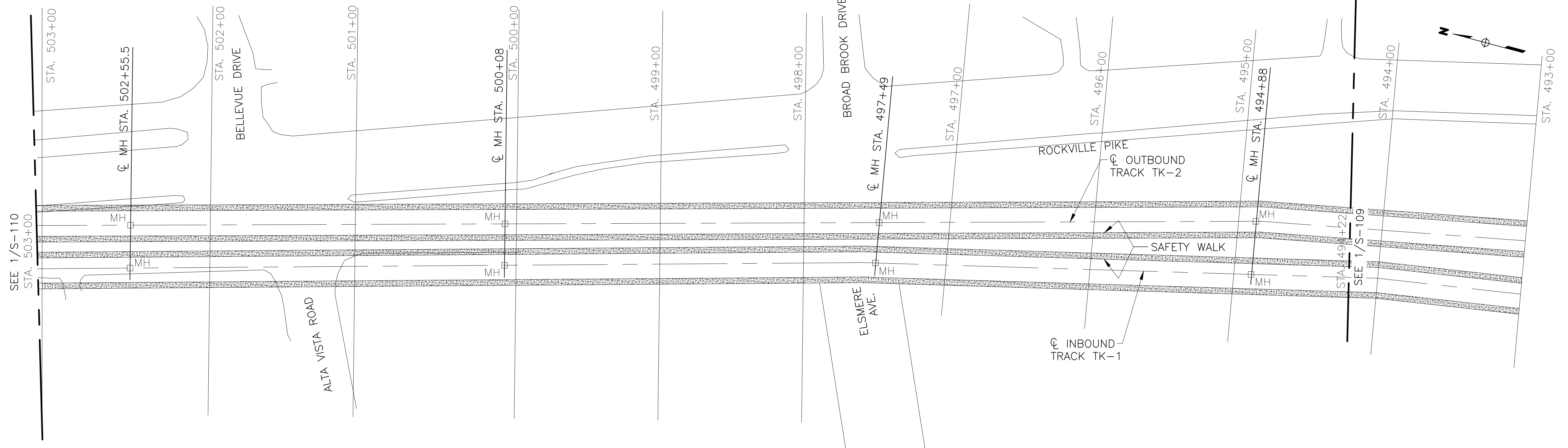

2  
S-109  
**STATIONING PLAN**  
SCALE: 1:500

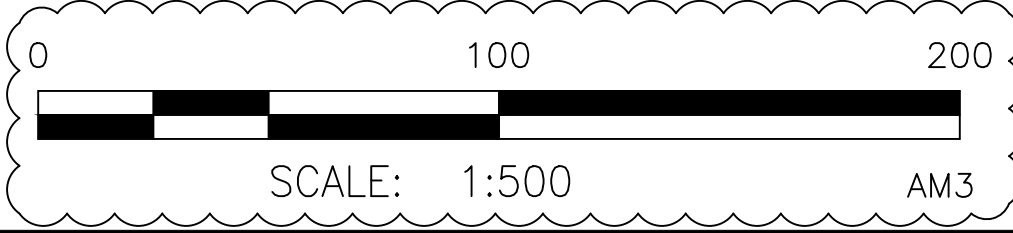

"PROFESSIONAL CERTIFICATION. I HEREBY CERTIFY THAT THESE DOCUMENTS WERE PREPARED OR APPROVED BY ME AND THAT I AM A DULY LICENSED PROFESSIONAL ENGINEER UNDER THE LAWS OF THE STATE OF MARYLAND, LICENSE NO. 22331, EXPIRATION DATE: 05-03-2015."

FINAL CONTRACT NO. FQ15093

DESIGNED		DATE		NUMBER		DESCRIPTION		DATE		BY		DESCRIPTION	
A. ZENDEK	01-15	01-15	01-15										
D. DILLON	01-15	01-15	01-15										
V. CECKA	01-15	01-15	01-15										
M. AVERSO	01-15	01-15	01-15										



**WASHINGTON METROPOLITAN AREA TRANSIT AUTHORITY**

DEPARTMENT OF TRANSIT INFRASTRUCTURE AND ENGINEERING SERVICES  
OFFICE OF INFRASTRUCTURE RENEWAL PROGRAM

**GFP** A Gannett Fleming/Parsons JOINT VENTURE

APPROVED \_\_\_\_\_ SUBMITTED \_\_\_\_\_ PROJECT MANAGER

**RED LINE REHAB.-FRIENDSHIP HEIGHTS TO GROSVENOR - PART 1**

STATIONING PLANS

SCALE AS NOTED DRAWING NO. S-109 SHEET NO. M1272-021

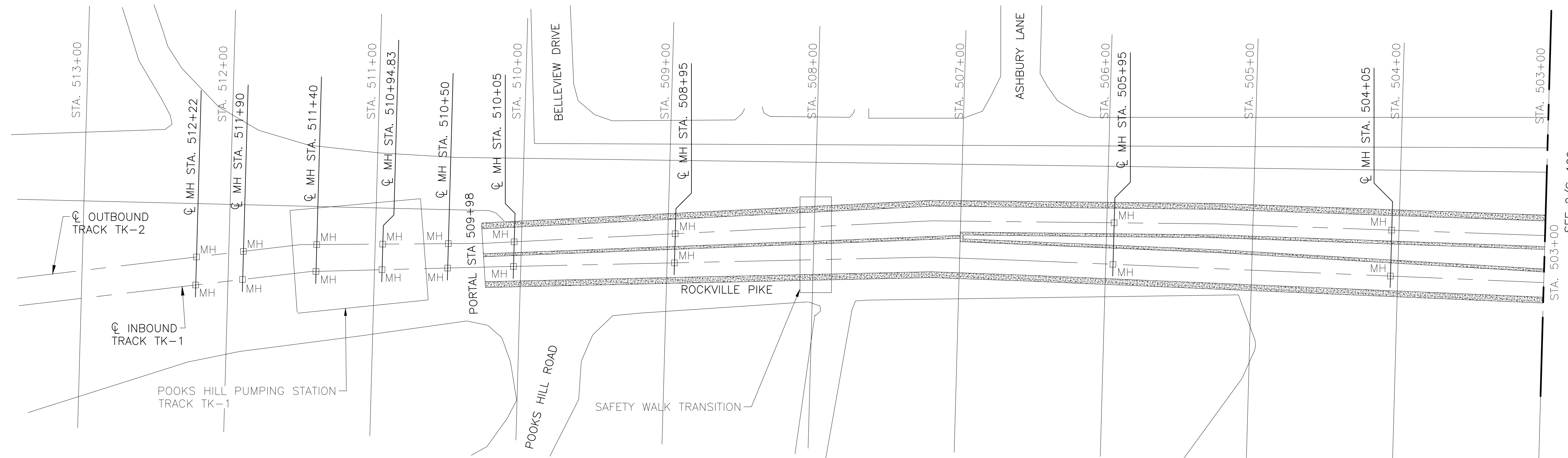
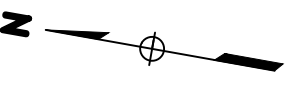

**1**  
S-110 **STATIONING PLAN**  
SCALE: 1:500

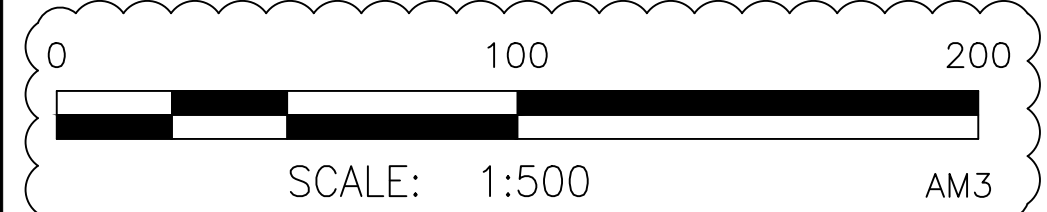

"PROFESSIONAL CERTIFICATION. I HEREBY CERTIFY THAT THESE DOCUMENTS WERE PREPARED OR APPROVED BY ME AND THAT I AM A DULY LICENSED PROFESSIONAL ENGINEER UNDER THE LAWS OF THE STATE OF MARYLAND, LICENSE NO. 22331, EXPIRATION DATE: 05-03-2015."

FINAL CONTRACT NO. FQ15093

DESIGNED			REFERENCE DRAWINGS			REVISIONS		
NUMBER	DESCRIPTION	DATE	NUMBER	DESCRIPTION	DATE	BY	DESCRIPTION	DATE
1	A. ZENDEK	01-15						
	D. DILLON	01-15						
	V. CECKA	01-15						
	M. AVERSO	01-15						



**WASHINGTON METROPOLITAN AREA TRANSIT AUTHORITY**

DEPARTMENT OF TRANSIT INFRASTRUCTURE AND ENGINEERING SERVICES  
OFFICE OF INFRASTRUCTURE RENEWAL PROGRAM

**GFP** A Gannett Fleming/Parsons JOINT VENTURE

APPROVED \_\_\_\_\_ SUBMITTED \_\_\_\_\_ PROJECT MANAGER

**RED LINE REHAB.-FRIENDSHIP HEIGHTS TO GROSVENOR - PART 1**

STATIONING PLANS

SCALE AS NOTED DRAWING NO. S-110 SHEET NO. M1272-022

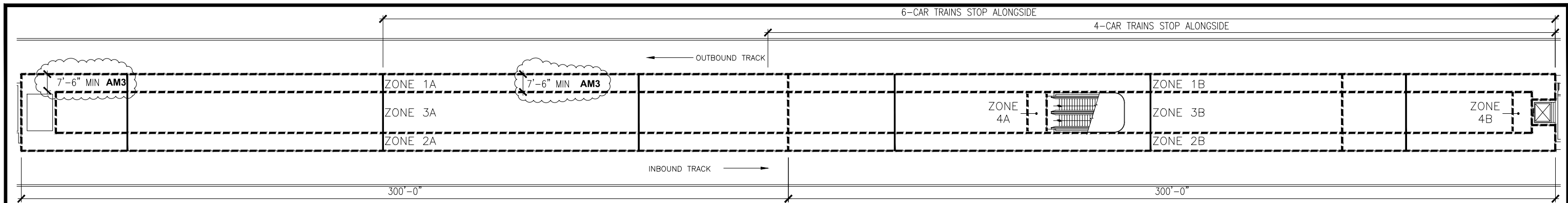

**1 PLATFORM - STAGING PLAN WORK ZONES SCALE: NTS**

**GENERAL PHASING NOTES**

- THE PHASING OUTLINE INDICATED IN THE DRAWING ABOVE IS FOR REFERENCE ONLY. THE CONTRACTOR IS RESPONSIBLE FOR DEVELOPING A PHASING PLAN FOR REVIEW AND APPROVAL BY THE AR.
- ALL WORK IN EACH PHASE MUST BE COMPLETE BEFORE THE CONTRACTOR IS PERMITTED TO PROCEED TO THE NEXT PHASE UNLESS AGREED TO BY WMATA.
- WORK PHASES WILL BE SEPARATED FROM REVENUE SPACES BY WOOD FRAME PARTITIONS WITH PLYWOOD FACES. IT IS THE RESPONSIBILITY OF THE CONTRACTOR TO DESIGN, INSTALL, AND MAINTAIN THIS WOODEN PARTITION WALL SYSTEM. PLYWOOD SURFACES THAT MAY BE IN CONTACT WITH THE PUBLIC SHOULD BE SMOOTH AND FREE OF SHARP EDGES.
- THE STATION WILL REMAIN IN OPERATION THROUGHOUT THE CONSTRUCTION PERIOD. SAFETY OF THE PUBLIC AND EMPLOYEES OF WMATA AND THE CONTRACTOR WILL BE OF THE GREATEST IMPORTANCE DURING THE CONSTRUCTION PERIOD.
- ALL SYSTEMS INCLUDING BUT NOT LIMITED TO LIGHTING, POWER, COMMUNICATIONS, TRAIN CONTROLS, AND SECURITY SHALL REMAIN OPERATIONAL DURING REVENUE SERVICE HOURS.
- ALL PHASING IS EXTREMELY TIME SENSITIVE. THE CONTRACTOR WILL VERIFY THAT HE HAS COORDINATED WITH ALL SUBS AND HAS ALL MATERIALS ON SITE TO COMPLETE THE WORK. DETAILED CRITICAL PATH METHOD (CPM) SCHEDULES ARE REQUIRED, AS WELL AS COORDINATION DRAWINGS. IF ALL OF THESE REQUIREMENTS HAVE NOT BEEN MET, PHASE WORKS WILL NOT BE PERMITTED TO PROCEED.
- CRANE OPERATION OVER THE TRACKS REQUIRES ADVANCE CLEARANCE WITH WMATA OBTAINED THROUGH THE ENGINEER.
- REMOVE DEBRIS FROM DEMOLITION DAILY KEEP TRACK AREA CLEAR OF DEBRIS AT ALL TIMES. THE CONTRACTOR SHALL TAKE NECESSARY STEPS TO PREVENT THE REMOVED MATERIAL FROM ENTERING THE EXISTING DRAINAGE FACILITIES. THE CONTRACTOR SHALL REMOVE THE DEBRIS RESULTING FROM DEMOLITION WORK TO A LOCATION OUTSIDE THE AUTHORITY'S RIGHT-OF-WAY PRIOR TO RESUMING FULL RAIL OPERATION OR TO PRE-APPROVED STAGING AREAS. ALL REMOVED MATERIALS AND DEBRIS TO BE DISPOSED OF PROPERLY AT NO ADDITIONAL COST TO THE OWNER

**STAGING NOTES**

- THE CONTRACTOR SHALL SUBMIT THE CONSTRUCTION SEQUENCE TO THE AUTHORITY'S REPRESENTATIVE (A.R.) FOR REVIEW PRIOR TO COMMENCING ANY DEMOLITION OR CONSTRUCTION ACTIVITIES. SUBMITTAL SHALL INCLUDE, BUT IS NOT LIMITED TO THE SEQUENCE OF SLAB REMOVAL AND INSTALLATION INCLUDING DETAILED DESIGN OF TEMPORARY SHORING.
- TEMPORARY BARRICADES FOR THE PROTECTION OF PASSENGERS SHALL BE PROVIDED AT ALL TIMES WHEN THE STATION IS OPEN TO PUBLIC.
- CONSTRUCT TEMPORARY PARTITIONS SEPARATING PHASES AT A MIN OF 2x4s @ 24" O.C. AND 5/8" PLYWOOD. ALL LUMBER IS TO BE FIRE-RATED.
- EXTEND ALL PARTITIONS TO UNDERSIDE OF CEILING ON PLATFORM LEVEL. BRACE PARTITIONS TO FLOORS WITH ANGLED 2x4s-ANCHOR TO FLOOR SECURELY.
- CONSTRUCT PARTITIONS 8'-0" HIGH ON PLATFORM LEVEL, ANCHOR TO FLOOR AS INDICATED IN NOTE 2. IT IS THE RESPONSIBILITY OF THE CONTRACTOR TO DESIGN, INSTALL AND MAINTAIN THIS WOODEN PARTITION WALL SYSTEM. PLYWOOD SURFACES THAT MAY BE IN CONTACT WITH THE PUBLIC SHOULD BE SMOOTH AND FREE OF SHARP EDGES.
- LOCATE ACCESS DOORS WHERE NEEDED FOR CONSTRUCTION ACTIVITIES. CONTRACTOR TO DETERMINE LOCATIONS. A.R. TO APPROVE.
- THE CONTRACTOR MAY EXTEND THE LENGTH OF THE WORK ZONE WITH WMATA'S APPROVAL, BUT MUST MAINTAIN MIN. 7'-6" FROM EDGE OF PLATFORM.
- THE CONTRACTOR SHALL PROVIDE TEMPORARY DECKING IF PAVER WORK IS NOT COMPLETED IN ORDER TO MAINTAIN PEDESTRIAN TRAFFIC AS DIRECTED DURING REVENUE SERVICE.

**STAGING NOTES (Cont.)**

- PROVIDE TEMPORARY WARNING SIGNAGE IN ACCORDANCE WITH WMATA REQUIREMENTS.
- PROVIDE TEMPORARY LIGHTING IN WORK ZONES INCLUDING STORAGE AREAS IN ACCORDANCE WITH WMATA DESIGN CRITERIA, VERSION 9. INSTALL TEMPORARY EDGE LIGHTING DURING REPLACEMENT OF THE CANTILEVER SLAB.
- CONSTRUCTION WORK AND STORAGE AREAS MUST BE APPROVED BY WMATA.
- CONTRACTOR MAY USE AN AREA OF UP TO 15' BY 75' AS A STAGING AREA ON THE PLATFORM THAT IS SECURED IN AN EIGHT-FOOT HIGH ENCLOSURE. LOCATION AND ENCLOSURE STRUCTURE SUBJECT TO REVIEW AND APPROVAL BY THE AR.

**SEQUENCE OF CONSTRUCTION**

**ZONES 1A, 1B, 2A, 2B**

- SET-UP STAGING AREA AND CRANE, INCLUDING UTILITY PROTECTION, GRADING, AND FENCING.
- RELOCATE UNDER PLATFORM UTILITIES AS REQUIRED.
- DEMOLISH EXISTING GRANITE EDGES AND GLASS LENSES. DEMOLISH TILE, SETTING BED, AND WATERPROOFING DOWN TO STRUCTURAL SLAB. STORE GRANITE FOR REUSE AT LOCATION AS DIRECTED BY AR
- SAWCUT EDGE OF CONCRETE PLATFORM IN ACCORDANCE WITH STRUCTURAL DRAWINGS AND SPECIFICATIONS.
- INSTALL TEMPORARY PROTECTION AS REQUIRED.
- INSTALL TOPPING SLAB, WATERPROOFING, GRANITE, AND PAVERS.

**ZONES 3A, 3B, 4A, 4B**

- SAME AS ITEM 1 ABOVE
- DEMOLISH PAVERS, SETTING BED, AND WATERPROOFING DOWN TO STRUCTURAL SLAB.
- INSTALL WATERPROOF TOPPING SLAB, MEMBRANE, AND PAVERS. SET ELEVATIONS FOR TOP OF PAVERS IN ACCORDANCE WITH INFORMATION PROVIDED ON PLATFORM PLANS.

**GENERAL NOTES:**

- ALL DIMENSIONS ARE NOMINAL UNLESS OTHERWISE NOTED. VERIFY ALL DIMENSIONS IN THE FIELD.
- VERIFY AND PROPERLY DOCUMENT ALL EXISTING FIELD CONDITIONS.
- ALL WORK IS DESIGNED AND SHALL BE CONSTRUCTED IN ACCORDANCE WITH WMATA DESIGN CRITERIA, VERSION 9.
- DO NOT SCALE DRAWINGS FOR PURPOSES OF CONSTRUCTION.
- ANY DEVIATION FROM, OR IN FIELD ALTERATION TO THESE DRAWINGS, AND SPECIFICATIONS IS STRICTLY PROHIBITED WITHOUT PRIOR APPROVAL OF AUTHORITY'S REPRESENTATIVE (A.R.). ANY SUCH ALTERATIONS SHALL BE CORRECTED AT ONCE, WITH NO EXPENSE TO THE OWNER.
- THE CONTRACTOR SHALL BE RESPONSIBLE FOR COORDINATING THE WORK OF ALL TRADES REGARDLESS OF DISCREPANCIES IN THE CONTRACT DOCUMENTS. NO ADDITIONAL COSTS WILL BE PAID BY THE OWNER TO RECTIFY WORK TO BE RELOCATED DUE TO LACK OF JOBSITE COORDINATION.
- DEMOLITION, CUTTING, AND PATCHING OF ANY MATERIALS OR FIXTURES REQUIRED TO CONSTRUCT THE PROJECT IS HEREIN MADE A PART OF THESE CONTRACT DOCUMENTS.
- THE CONTRACTOR SHALL SECURE AND PAY FOR ALL PERMITS.
- ALL WORK INDICATED OR SHOWN GRAPHICALLY AS "EXISTING TO REMAIN" WILL BE THE CONTRACTOR'S RESPONSIBILITY TO PROTECT AND WORK AROUND WITHOUT DISTURBING. IF DAMAGED, THE CONTRACTOR WILL REPLACE OR REPAIR AT THE AUTHORITY'S DIRECTION AT NO ADDITIONAL COST TO THE OWNER.

"PROFESSIONAL CERTIFICATION. I HEREBY CERTIFY THAT THESE DOCUMENTS WERE PREPARED OR APPROVED BY ME, AND THAT I AM A DULY LICENSED PROFESSIONAL ARCHITECT UNDER THE LAWS OF THE STATE OF MARYLAND, LICENSE NO. 5231-A, EXPIRATION DATE: 05-18-2017."

FINAL CONTRACT NO. FQ15093

DESIGNED PROJECT TEAM			DATE		REFERENCE DRAWINGS			REVISIONS		
NUMBER	DESCRIPTION	DATE	BY	DESCRIPTION	NUMBER	DESCRIPTION	DATE	BY	DESCRIPTION	
1	CLR	4/30/14	7/31/15	C.R.	1	CLEARANCE REVISION - AM3				
2	RES, DO	7/16/14								
3	JP	7/22/14								
4		7/28/14								

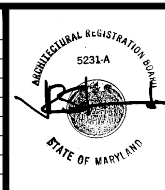

**WASHINGTON METROPOLITAN AREA TRANSIT AUTHORITY**  
 DEPARTMENT OF TRANSIT INFRASTRUCTURE AND ENGINEERING SERVICES  
 OFFICE OF INFRASTRUCTURE RENEWAL PROGRAM

**GFP** A Gannett Fleming/Parsons JOINT VENTURE

APPROVED \_\_\_\_\_ SUBMITTED \_\_\_\_\_ PROJECT MANAGER

**RED LINE REHAB.-FRIENDSHIP HEIGHTS TO GROSVENOR - PART 4**

STAGING PLAN

SCALE AS SHOWN DRAWING NO. A11-G-001 SHEET NO. M1272-141

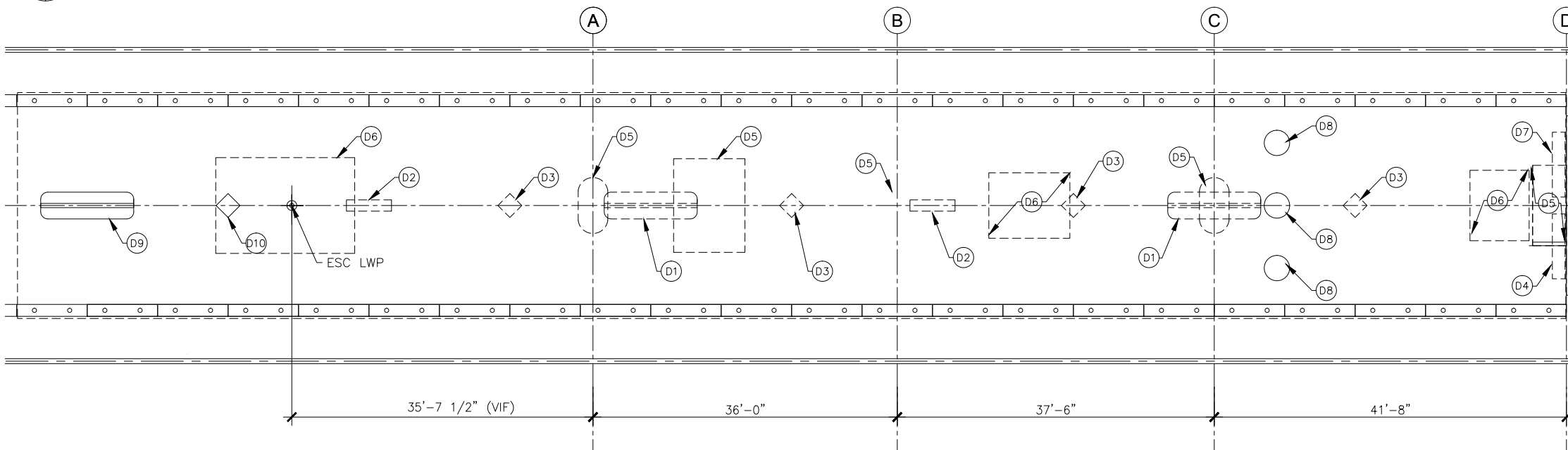

1 PARTIAL PLATFORM PLAN - DEMOLITION - 1B  
A-100 SCALE: 1/8" = 1'-0"

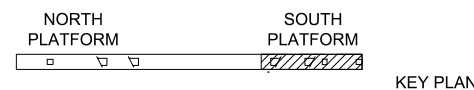

DEMOLITION NOTES FOR 1B

- (D1) REMOVE AND STORE EXISTING BENCH FOR SALVAGE OR RE-USE.
- (D2) REMOVE AND STORE EXISTING DIORAMA FOR SALVAGE OR RE-USE
- (D3) REMOVE PYLONS.
- (D4) A.R. WILL RELOCATE EXISTING ETEC CABINET. AM3
- (D5) REMOVE EXISTING SLAB AS REQUIRED TO FACILITATE INSTALLATION OF PROPOSED COLUMNS, STAIRS AND MECH SHAFT. SEE STRUCT, MECH AND ELECT WORK.
- (D6) REMOVE EXISTING SLAB AS REQUIRED TO FACILITATE INSTALLATION OF KNOCK-OUT PANEL FOR PROPOSED ESCALATOR AND ELEVATORS. SEE ELECT & STRUCT WORK.
- (D7) A.R. WILL RELOCATE CWS CABINET. AM3
- (D8) EXIST MANHOLE COVER TO REMAIN
- (D9) EXIST BENCH TO REMAIN
- (D10) EXIST PYLON TO REMAIN

WORK ZONE NOTES

- 1. DESIGN BUILDER SHALL PERFORM THEIR WORK IN A MANNER THAT ALLOWS FOR FULL USE OF THE STATION DURING PERIODS OTHER THAN AGREED TO STATION CLOSURES AS SCHEDULED.

ABBREVIATIONS

EXIST	EXISTING
W/	WITH
STRUCT	STRUCTURAL
ARCH	ARCHITECTURAL
ELECT	ELECTRICAL
MECH	MECHANICAL
DWGS	DRAWINGS
CONC	CONCRETE
SYS	SYSTEM
TYP	TYPICAL
MEZZ	MEZZANINE
ELEV	ELEVATOR
ESC	ESCALATOR
COORD	COORDINATE
LWP	LOWER WORKING POINT
UWP	UPPER WORKING POINT
VIF	VERIFY IN FIELD

GENERAL DEMOLITION NOTES

- 1. DIMENSIONS BASED ON RECORD DWGS. DESIGN BUILDER SHALL VERIFY EXISTING FIELD CONDITIONS.
- 2. PRIOR TO DEMOLITION, VERIFY MATERIALS AND EQUIPMENT TO BE SALVAGED. STORE WHERE DIRECTED BY WMATA (OWNER). SOME ITEMS MAY BE INCORPORATED INTO NEW WORK.
- 3. VERIFY AND MARK ALL UNDER SLAB UTILITIES PRIOR TO THE START OF WORK.
- 4. REMOVE ALL RUBBISH AND DEMOLITION DEBRIS FROM THE SITE AND DISPOSE OF IN A LAWFUL MANNER.
- 5. COORDINATE GENERAL CONSTRUCTION DEMOLITION W/ THE WORK OF OTHER TRADES.
- 6. REPAIR ALL EXIST STRUCTURES, UTILITIES, AND EQUIPMENT, SCHEDULED TO REMAIN, WHICH ARE DAMAGED DURING DEMOLITION OPERATIONS. ALL WORK SCHEDULED TO BE DEMOLISHED, WILL BE REMOVED COMPLETELY INCLUDING ALL FASTENERS, ATTACHMENTS, ACCESSORIES, OR ANY RELATED WORK.

- 7. DEMOLITION OF CONC SLABS IS SHOWN ON THE DEMOLITION PLAN AS IT RELATES TO DEMOLITION FOR OTHER TRADES SUCH AS STRUCT FOUNDATIONS. SEE ELECT AND STRUCT DOCUMENTS FOR RELATED DEMOLITION WORK.
- 8. DEMOLITION INCLUDES ALL ITEMS WHETHER OR NOT SHOWN ON THE DWGS, THAT ARE REQUIRED TO BE REMOVED IN ORDER TO INSTALL THE NEW WORK SHOWN ON DRAWING A-102, A-103 AND OTHER PORTIONS OF THE CONTRACT DOCUMENTS.
- 9. ALL SURFACES TO REMAIN SHALL BE REFINISHED TO REPAIR ALL HOLES, SCRATCHES, DENTS, MARS, PITTING, ADHESIVE, BAD JOINTS, DEFECTIVE CMU, ETC. TO BE ACCEPTABLE IN EVERY WAY TO RECEIVE NEW FINISHES.
- 10. DESIGN BUILDER WILL COORDINATE LOCATIONS OF ALL UTILITIES IN PLENUM AREA BELOW PLATFORM AND VERIFY THAT ALL WORK IS COORDINATED.
- 11. DESIGN BUILDER IS RESPONSIBLE FOR ALL EQUIPMENT, FURNISHING AND SIGNAGE WHETHER SHOWN OR NOT. DESIGN BUILDER SHALL COORDINATE, REMOVE, PROTECT AND REINSTALL ALL EQUIPMENT, FURNISHING AND SIGNAGE AS REQUIRED TO PROVIDE FOR FUNCTIONAL OPERATIONS BY WMATA.

FINAL CONTRACT NO. FQ15093

DESIGNED		DATE		REFERENCE DRAWINGS		REVISIONS	
NUMBER	DESCRIPTION	DATE	BY	DESCRIPTION	DATE	BY	DESCRIPTION
AD		2/20/15					
AD		2/20/15					
RES		2/20/15			7/31/15	C.R.	REVISED DEMO NOTES - AM3
JP		2/20/15					

WASHINGTON METROPOLITAN AREA TRANSIT AUTHORITY

DEPARTMENT OF TRANSIT INFRASTRUCTURE AND ENGINEERING SERVICES  
OFFICE OF INFRASTRUCTURE RENEWAL PROGRAM

APPROVED \_\_\_\_\_

GFP A Gannett Fleming/Parsons JOINT VENTURE

SUBMITTED \_\_\_\_\_  
PROJECT MANAGER

RED LINE REHAB.-FRIENDSHIP HEIGHTS TO GROSVENOR - PART 6

PHASE 1B  
PLATFORM DEMOLITION PLAN

SCALE AS SHOWN

DRAWING NO. A09-A-100

SHEET NO. M1272-191

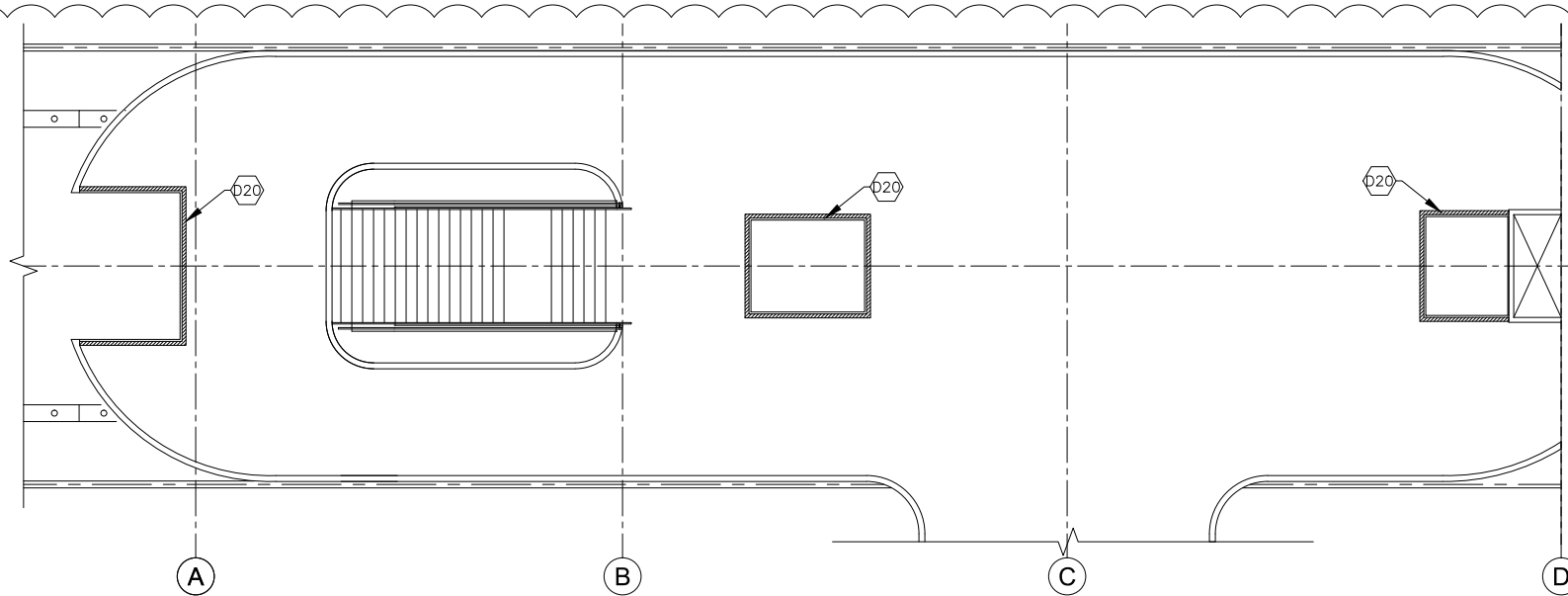

AM3

1 MEZZANINE PLAN - FUTURE WORK (NIC)  
A-100 SCALE: 1/8" = 1'-0"

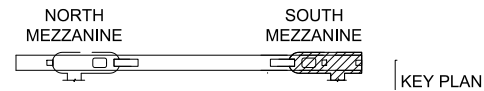

DEMOLITION NOTES FOR 2

- D20 REMOVE PROTECTION BARRIERS FOR INITIATION OF REVENUE SERVICE
- D21 REMOVE KNOCKOUT PANEL AND PREPARE SURFACE FOR ELEVATOR
- D22 REMOVE KNOCKOUT PANEL AND PREPARE SURFACE FOR ESCALATOR

WORK ZONE NOTES

1. DESIGN BUILDER SHALL PERFORM THEIR WORK IN A MANNER THAT ALLOWS FOR FULL USE OF THE STATION DURING PERIODS OTHER THAN AGREED TO STATION CLOSURES AS SCHEDULED.

ABBREVIATIONS

EXIST	EXISTING
W/	WITH
STRUCT	STRUCTURAL
ARCH	ARCHITECTURAL
ELECT	ELECTRICAL
MECH	MECHANICAL
DWGS	DRAWINGS
CONC	CONCRETE
SYS	SYSTEM
TYP	TYPICAL
MEZZ	MEZZANINE
ELEV	ELEVATOR
ESC	ESCALATOR
COORD	COORDINATE
LWP	LOWER WORKING POINT
UWP	UPPER WORKING POINT
VIF	VERIFY IN FIELD

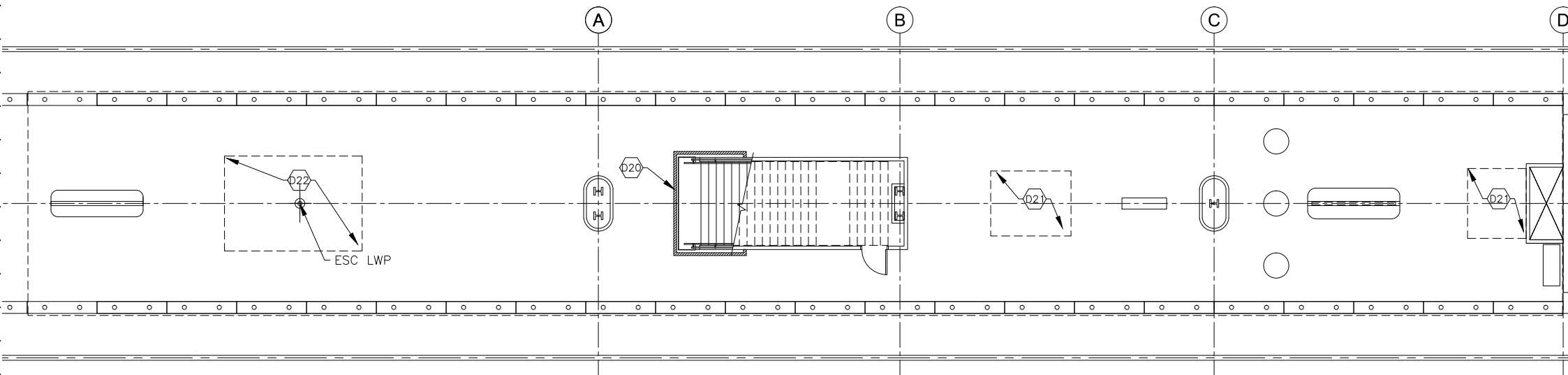

2 PARTIAL PLATFORM PLAN - FUTURE WORK (NIC)  
A-100 SCALE: 1/8" = 1'-0"

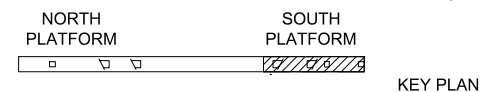

GENERAL DEMOLITION NOTES

1. DIMENSIONS BASED ON RECORD DWGS. DESIGN BUILDER SHALL VERIFY EXISTING FIELD CONDITIONS.
2. PRIOR TO DEMOLITION, VERIFY MATERIALS AND EQUIPMENT TO BE SALVAGED. STORE WHERE DIRECTED BY WMATA (OWNER). SOME ITEMS MAY BE INCORPORATED INTO NEW WORK.
3. VERIFY AND MARK ALL UNDER SLAB UTILITIES PRIOR TO THE START OF WORK.
4. REMOVE ALL RUBBISH AND DEMOLITION DEBRIS FROM THE SITE AND DISPOSE OF IN A LAWFUL MANNER.
5. COORDINATE GENERAL CONSTRUCTION DEMOLITION W/ THE WORK OF OTHER TRADES.
6. REPAIR ALL EXIST STRUCTURES, UTILITIES, AND EQUIPMENT, SCHEDULED TO REMAIN, WHICH ARE DAMAGED DURING DEMOLITION OPERATIONS. ALL WORK SCHEDULED TO BE DEMOLISHED, WILL BE REMOVED COMPLETELY INCLUDING ALL FASTENERS, ATTACHMENTS, ACCESSORIES, OR ANY RELATED WORK.
7. DEMOLITION OF CONC SLABS IS SHOWN ON THE DEMOLITION PLAN AS IT RELATES TO DEMOLITION FOR OTHER TRADES SUCH AS STRUCT FOUNDATIONS. SEE ELECT AND STRUCT DOCUMENTS FOR RELATED DEMOLITION WORK.
8. DEMOLITION INCLUDES ALL ITEMS WHETHER OR NOT SHOWN ON THE DWGS, THAT ARE REQUIRED TO BE REMOVED IN ORDER TO INSTALL THE NEW WORK SHOWN ON DRAWING A-102, A-103 AND OTHER PORTIONS OF THE CONTRACT DOCUMENTS.
9. ALL SURFACES TO REMAIN SHALL BE REFINISHED TO REPAIR ALL HOLES, SCRATCHES, DENTS, MARS, PITTING, ADHESIVE, BAD JOINTS, DEFECTIVE CMU, ETC. TO BE ACCEPTABLE IN EVERY WAY TO RECEIVE NEW FINISHES.
10. DESIGN BUILDER WILL COORDINATE LOCATIONS OF ALL UTILITIES IN PLENUM AREA BELOW PLATFORM AND VERIFY THAT ALL WORK IS COORDINATED.
11. DESIGN BUILDER IS RESPONSIBLE FOR ALL EQUIPMENT, FURNISHING AND SIGNAGE WHETHER SHOWN OR NOT. DESIGN BUILDER SHALL COORDINATE, REMOVE, PROTECT AND REINSTALL ALL EQUIPMENT, FURNISHING AND SIGNAGE AS REQUIRED TO PROVIDE FOR FUNCTIONAL OPERATIONS BY WMATA.

FINAL CONTRACT NO. FQ15093

DESIGNED AD	2/20/15 DATE	REFERENCE DRAWINGS		REVISIONS	
		NUMBER	DESCRIPTION	DATE	DESCRIPTION
DRAWN AD	2/20/15 DATE			7/31/15	C.R. DRAWING CHANGES - AM3
CHECKED RES	2/20/15 DATE				
APPROVED JP	2/20/15 DATE				

WASHINGTON METROPOLITAN AREA TRANSIT AUTHORITY

DEPARTMENT OF TRANSIT INFRASTRUCTURE AND ENGINEERING SERVICES  
OFFICE OF INFRASTRUCTURE RENEWAL PROGRAM



APPROVED \_\_\_\_\_

SUBMITTED \_\_\_\_\_  
PROJECT MANAGER

RED LINE REHAB.-FRIENDSHIP HEIGHTS TO GROSVENOR - PART 6

FUTURE WORK (NIC)  
PLATFORM DEMOLITION PLAN

SCALE AS SHOWN

DRAWING NO. A09-A-101

SHEET NO. M1272-192

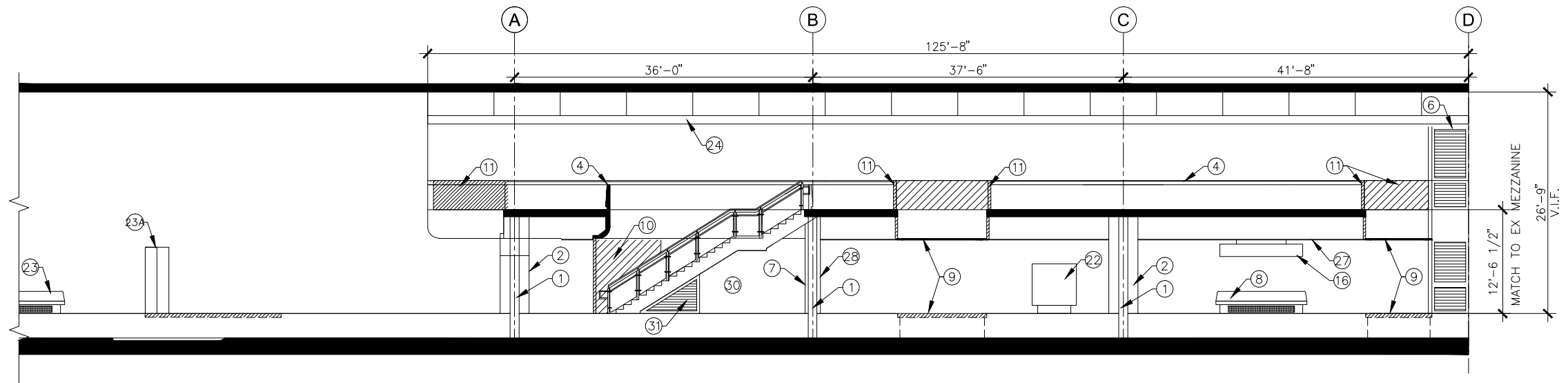

1 LONGITUDINAL SECTION - PHASE 1B  
A-301 SCALE: 1/8" = 1'-0"

GENERAL NOTES

1. VERIFY ALL DIMENSIONS IN THE FIELD.
2. VERIFY ALL FIELD CONDITIONS.
3. ALL DIMENSIONS ARE NOMINAL UNLESS NOTED OTHERWISE.
4. ALL WORK WILL BE COMPLETED IN ACCORDANCE WITH THE LATEST VERSIONS OF I.B.C. AND LIFE SAFETY CODES. ALL WORK IS DESIGNED AND SHALL BE CONSTRUCTED IN ACCORDANCE W/ WMATA DESIGN CRITERIA, VERSION 9.
5. DO NOT SCALE DWGS FOR PURPOSES OF FINAL DESIGN
6. DEMOLITION, CUTTING, AND PATCHING OF ANY MATERIALS OR FIXTURES REQUIRED TO CONSTRUCT THE PROJECT IS HEREIN MADE A PART OF THESE DOCUMENTS.
7. THE CONTRACTOR SHALL SECURE AND PAY FOR ALL PERMITS AS REQUIRED.
8. THE IMAGES ON THE CONSTRUCTION DOCUMENT FLOOR PLANS REFLECT THE INFORMATION FROM THE ORIGINAL CONSTRUCTION DOCUMENTS FOR THE PROJECT, IT IS NOT AN INDICATION OF NEW WORK, IT IS SHOWN IN GRAY LINE COLOR. THE NEW WORK AND REQUIRED DEMOLITION OR REMOVALS ARE SHOWN IN BLACK LINE COLOR. IF THE DIFFERENCE IS NOT OBVIOUS, REPORT TO THE A.R. IMMEDIATELY.
9. ALL WORK INDICATED OR SHOWN GRAPHICALLY AS "EXIST (EXISTING) TO REMAIN" WILL BE THE CONTRACTOR'S RESPONSIBILITY TO PROTECT AND WORK AROUND WITHOUT DISTURBING. IF DAMAGED, THE CONTRACTOR WILL REPLACE AT NO ADDITIONAL COST TO THE OWNER.
10. FIREPROOF ALL NEW STRUCT STEEL, INCLUDING, BUT NOT LIMITED TO COLUMNS, BEAMS, METAL DECK, AND MISCELLANEOUS METALS - SEE SPECIFICATION SECTION 07.81.00.
11. FORMWORK FOR PRECAST CONCRETE TO MATCH FORMWORK USED AT THE NORTH MEZZANINE STAIR.

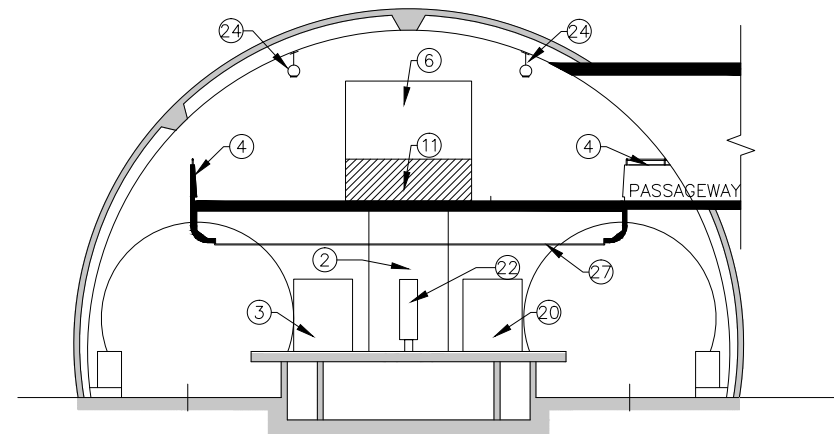

2 TRANSVERSE SECTION - PHASE 1B  
A-301 SCALE: 1/8" = 1'-0"

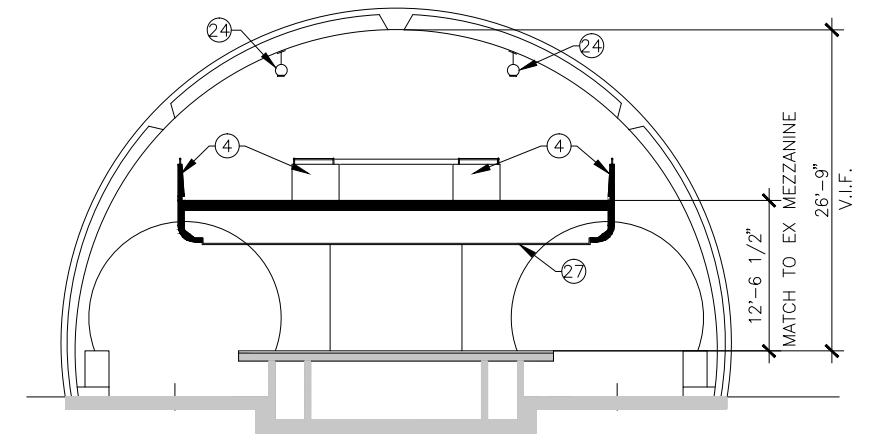

3 TRANSVERSE SECTION - PHASE 1B  
A-301 SCALE: 1/8" = 1'-0"

SHEET NOTES

SEE A-102 FOR "SHEET NOTES FOR PHASE 1B" (X)

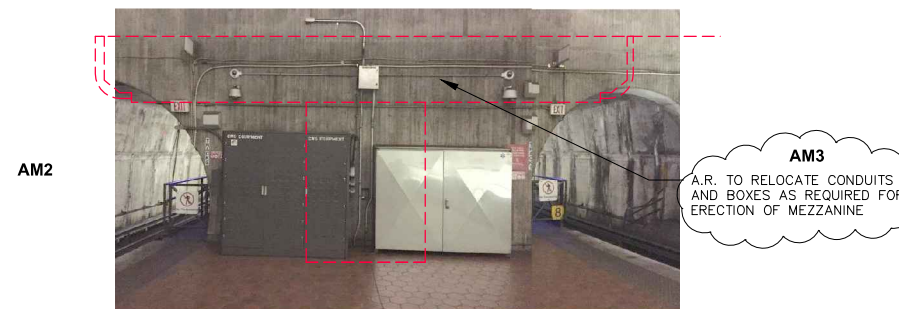

4 END WALL ELEVATION  
A-301 SCALE: N.T.S.

FINAL CONTRACT NO. FQ15093

DESIGNED	AD	2/20/15	REFERENCE DRAWINGS		REVISIONS		
			NUMBER	DESCRIPTION	DATE	BY	DESCRIPTION
DRAWN	AD	2/20/15			6/26/15	C.R.	CONSTRUCTION COORDINATION NOTES - AM2
CHECKED	RES	2/20/15			7/7/15	C.R.	CONSTRUCTION COORDINATION NOTES - AM3
APPROVED	JP	2/20/15					

WASHINGTON METROPOLITAN AREA TRANSIT AUTHORITY

DEPARTMENT OF TRANSIT INFRASTRUCTURE AND ENGINEERING SERVICES  
OFFICE OF INFRASTRUCTURE RENEWAL PROGRAM

APPROVED \_\_\_\_\_

**GFP** A Gannett Fleming/Parsons JOINT VENTURE

SUBMITTED \_\_\_\_\_ PROJECT MANAGER

RED LINE REHAB.-FRIENDSHIP HEIGHTS TO GROSVENOR - PART 6

PHASE 1B SECTIONS

SCALE AS SHOWN

DRAWING NO. A09-A-301

SHEET NO. M1272-195